

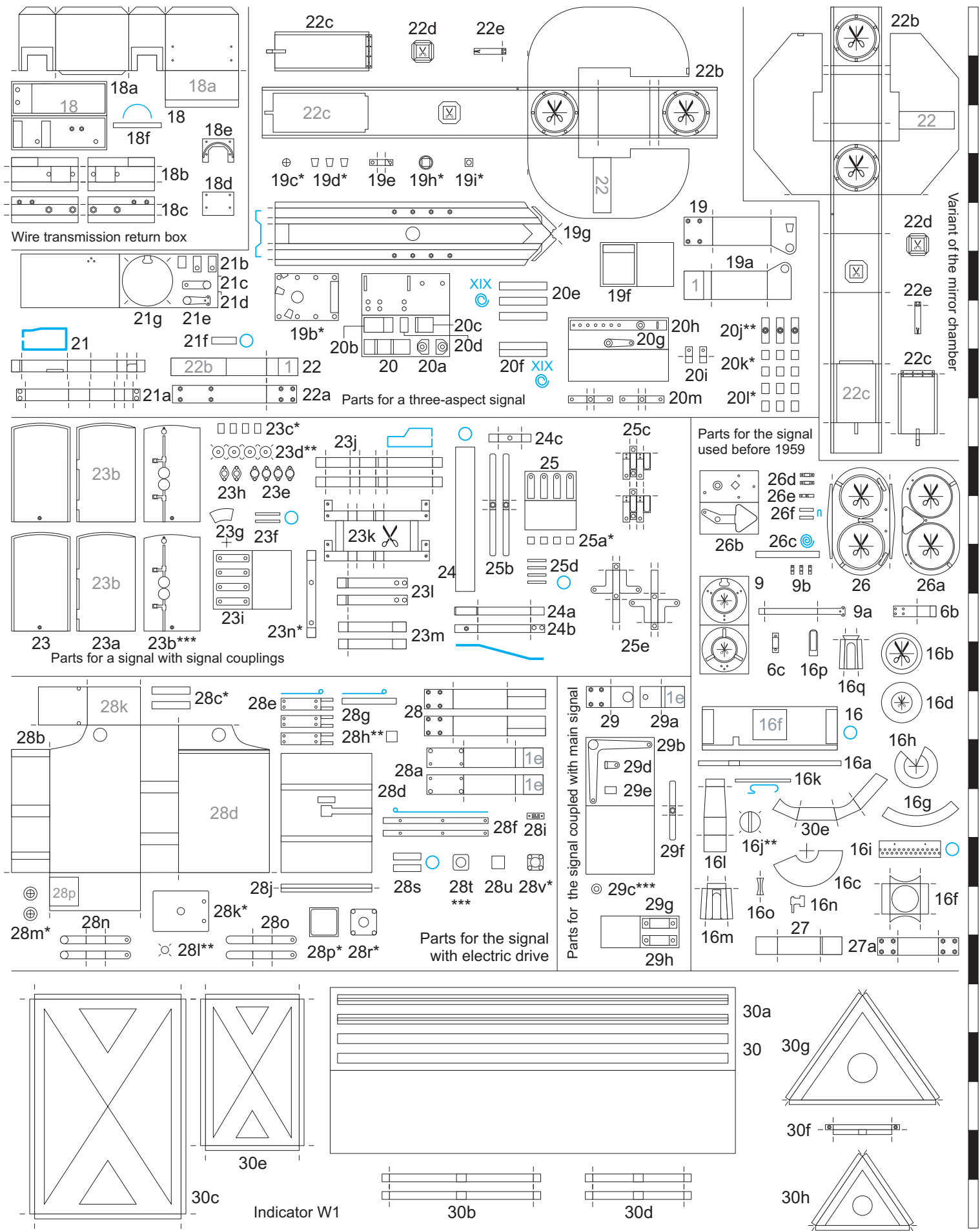























Mechanical distant signal, scale 1:25



Mechanical distant signal, scale 1:25

1cm

Templates

-  I (wire)
-  II (wire)
-  III (wire)
-  IV (orange film)
-  V (green film)
-  VI (wire)
-  VII (wire)
-  VIII (wire)
-  IX (wire)
-  X (wire)
-  XI (wire)
-  XII (wire)
-  XIII (white film)
-  XIV (clear film)
-  XV (white film)
-  XVI (wire)
-  XVII (wire)
-  XVIII (wire)
-  XIX (wire)
-  XX (wire)
-  XXI (wire)
-  XXII (clear film)
-  XXIII (green film)
-  XXIV (white film)

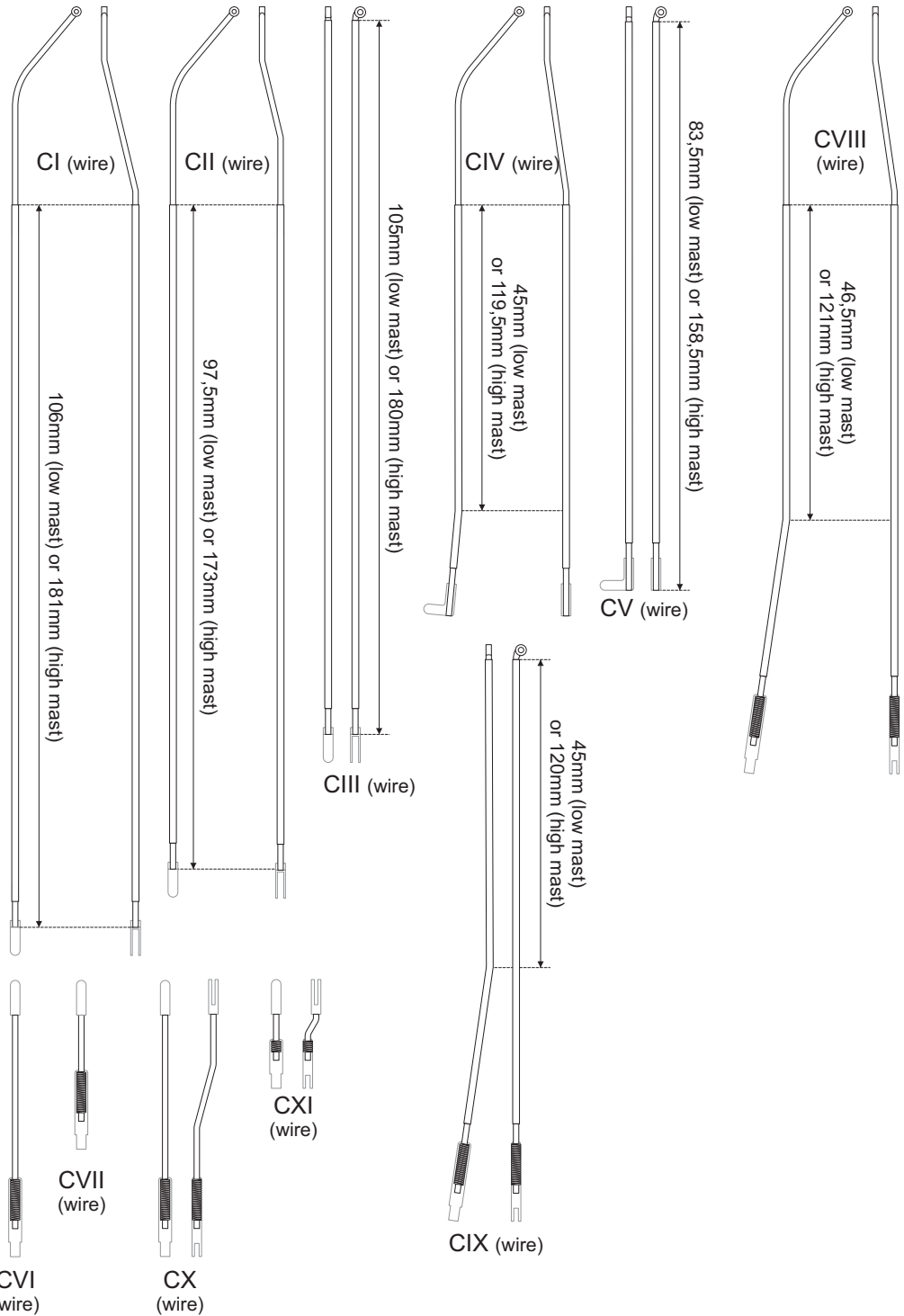

Mechanical distant signal, scale 1:25

1cm

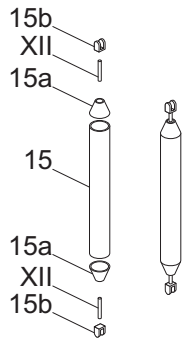
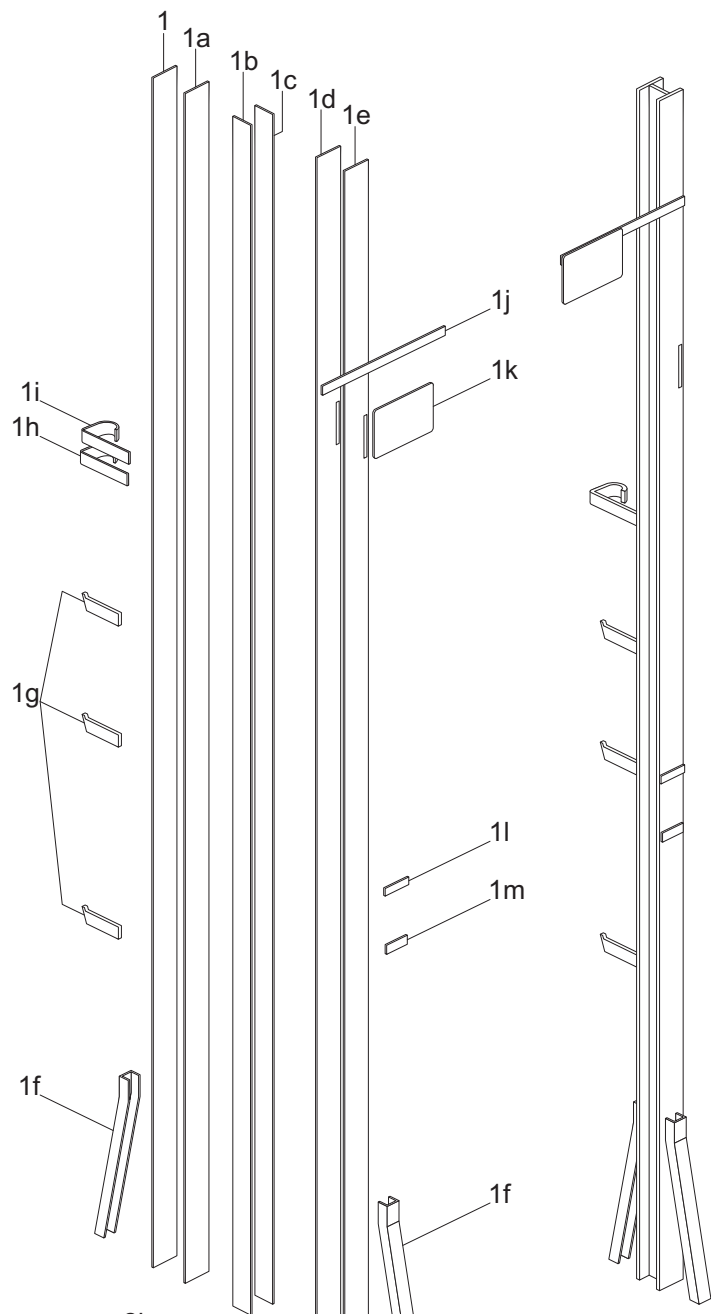

Skip these steps
when assembling
signal couplings.

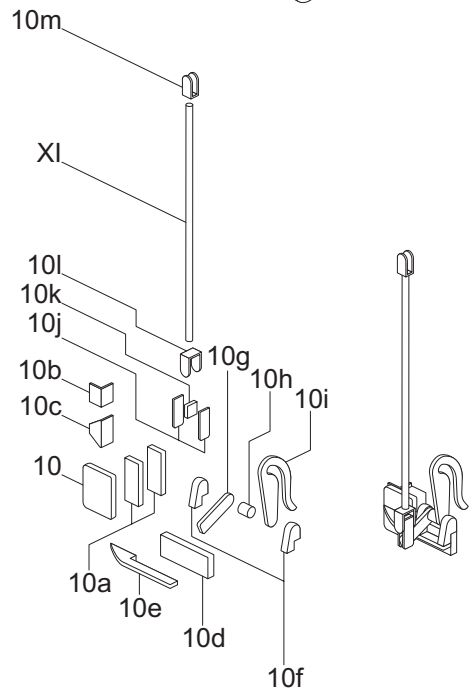
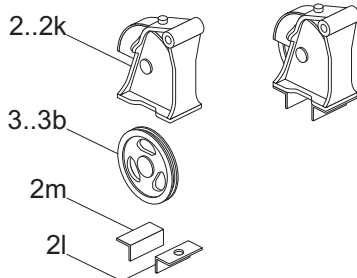
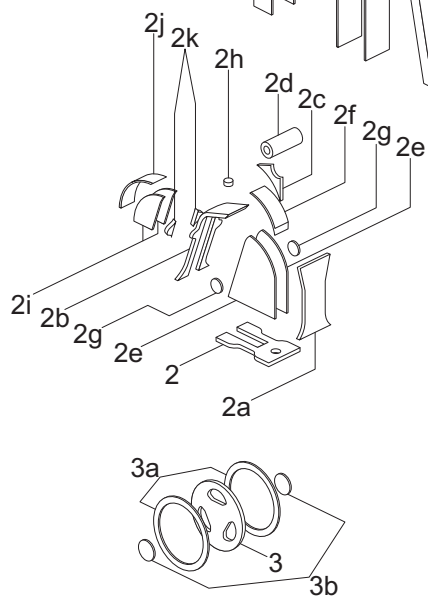
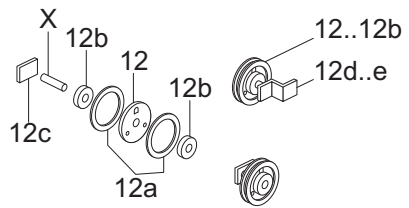
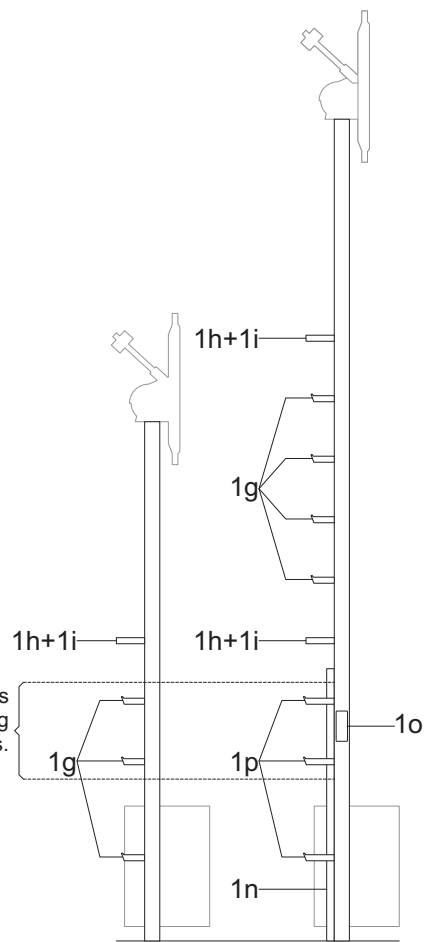

Mechanical distant signal, scale 1:25

Assembly manual 1/8

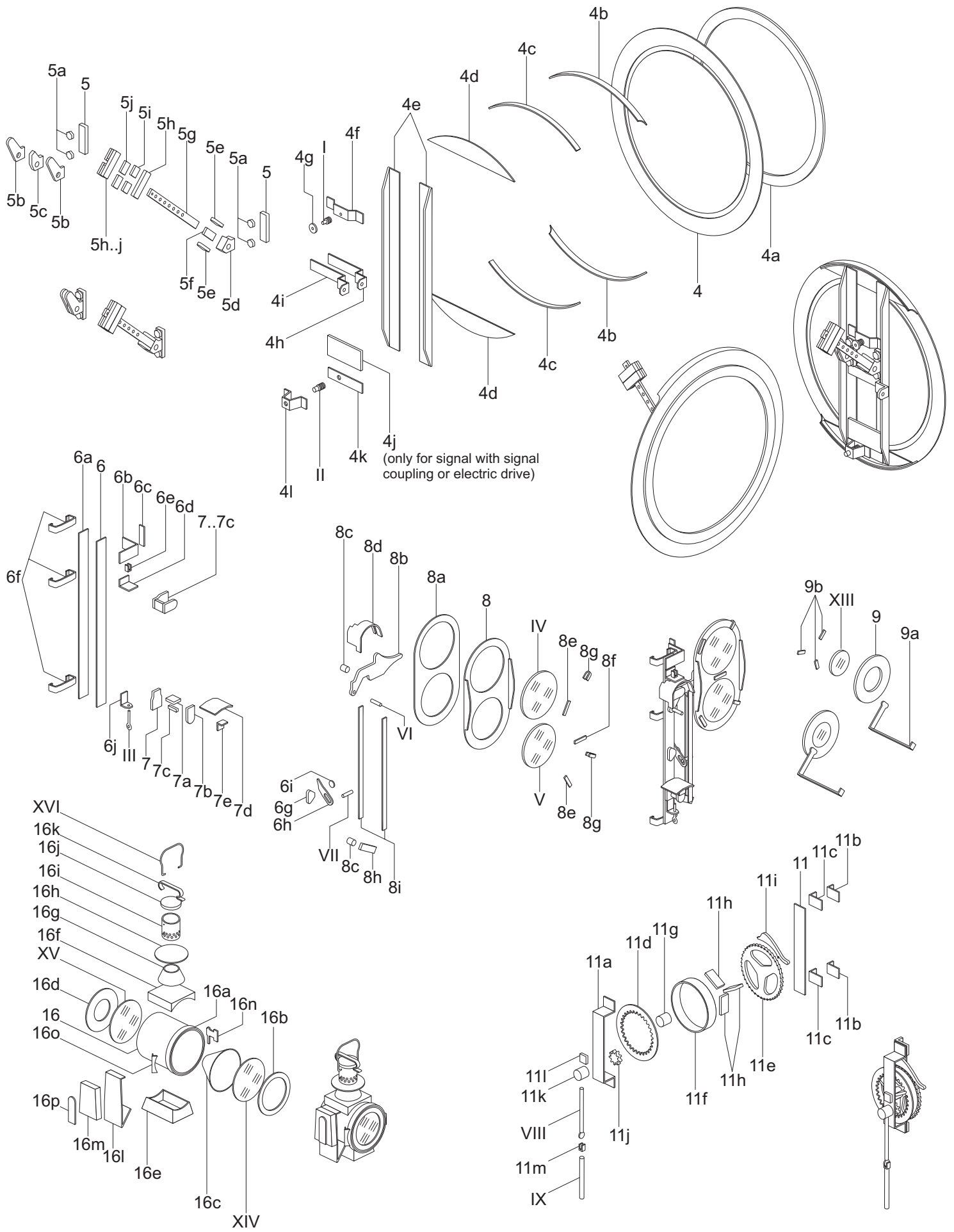

Mechanical distant signal, scale 1:25

Assembly manual 2/8

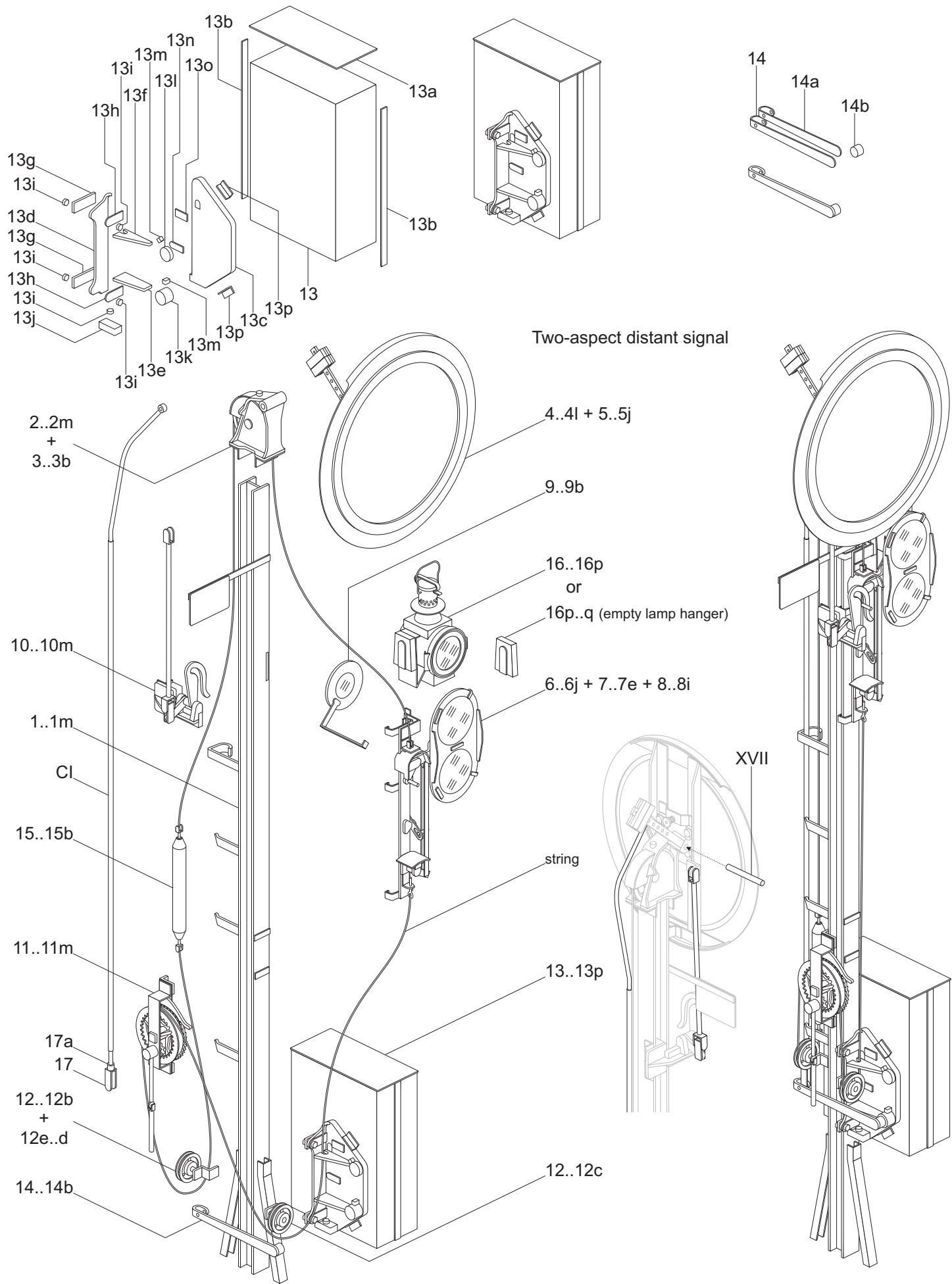

Mechanical distant signal, scale 1:25

Assembly manual 3/8

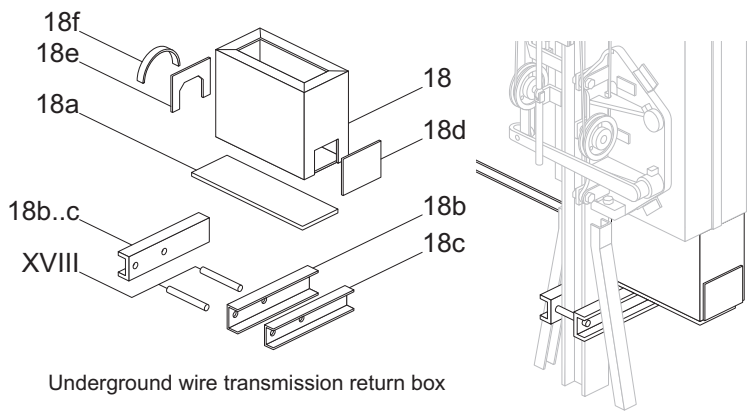

Underground wire transmission return box

Disk holder on a two-aspect signal with moving arrow.

In this version skip parts 10..10m, and do not put green lens in the upper shutter (part V).

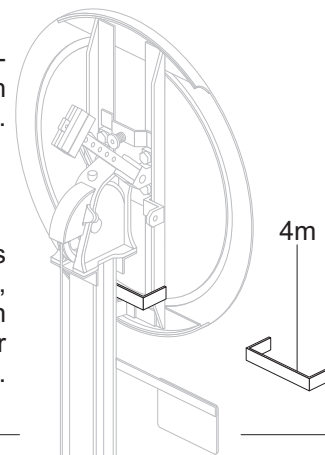

Parts of the three-aspect signal

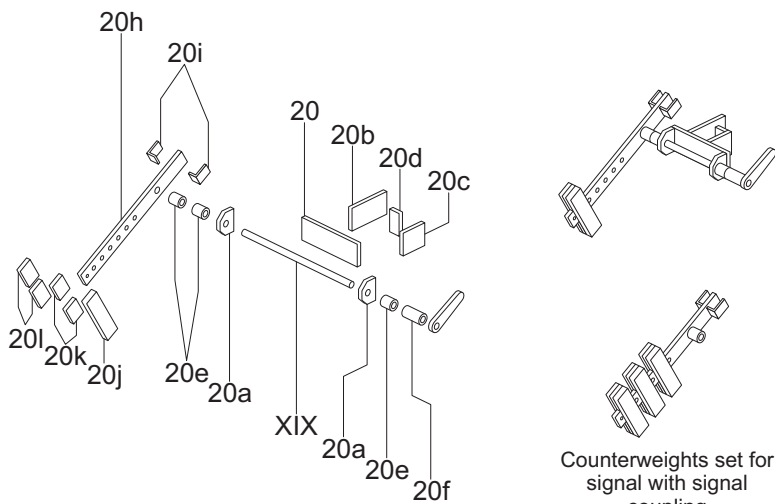

Counterweights set for signal with signal coupling

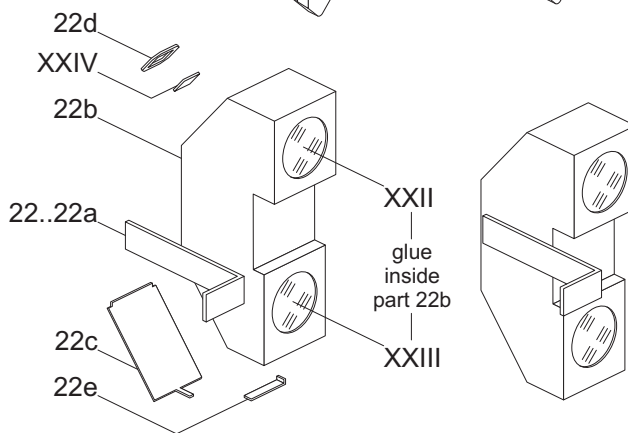
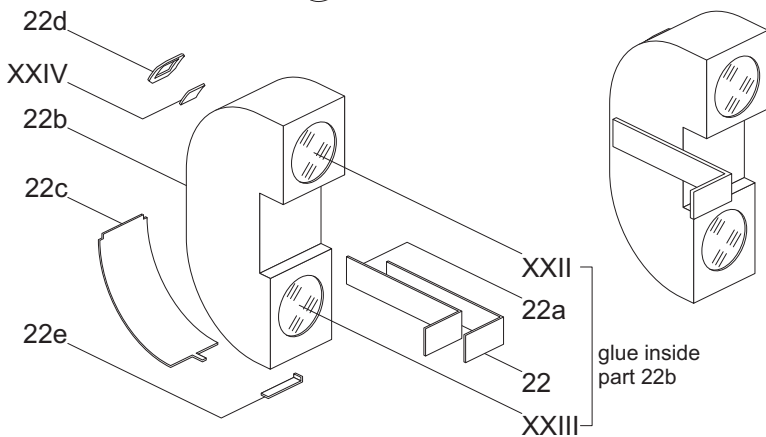
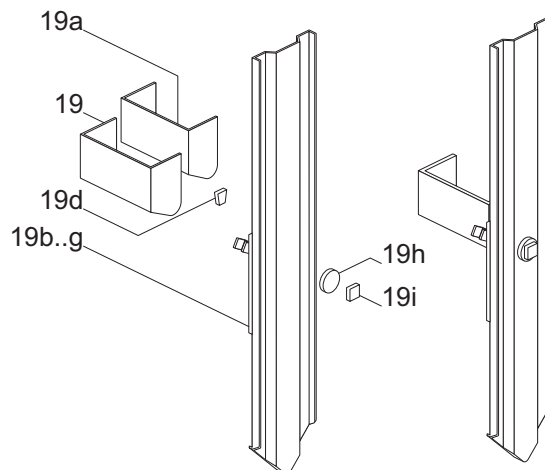
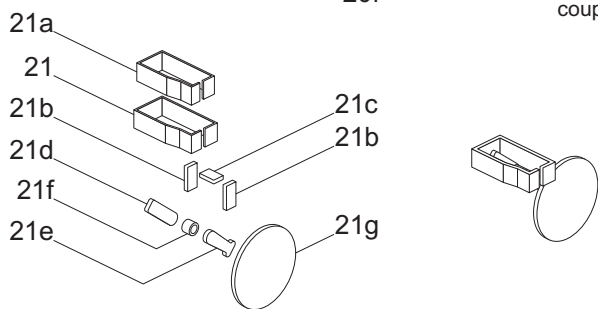
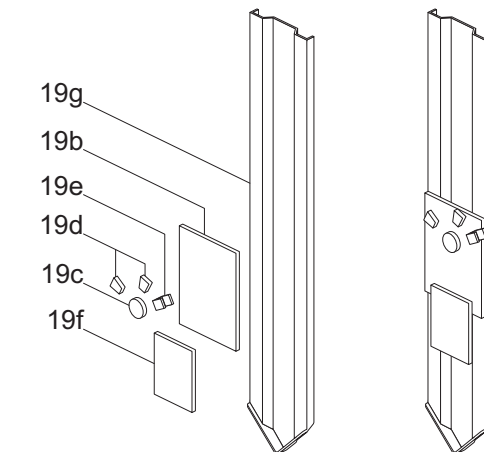

Variant of the mirror chamber

Mechanical distant signal, scale 1:25

Assembly manual 4/8

Three-aspect distant signal

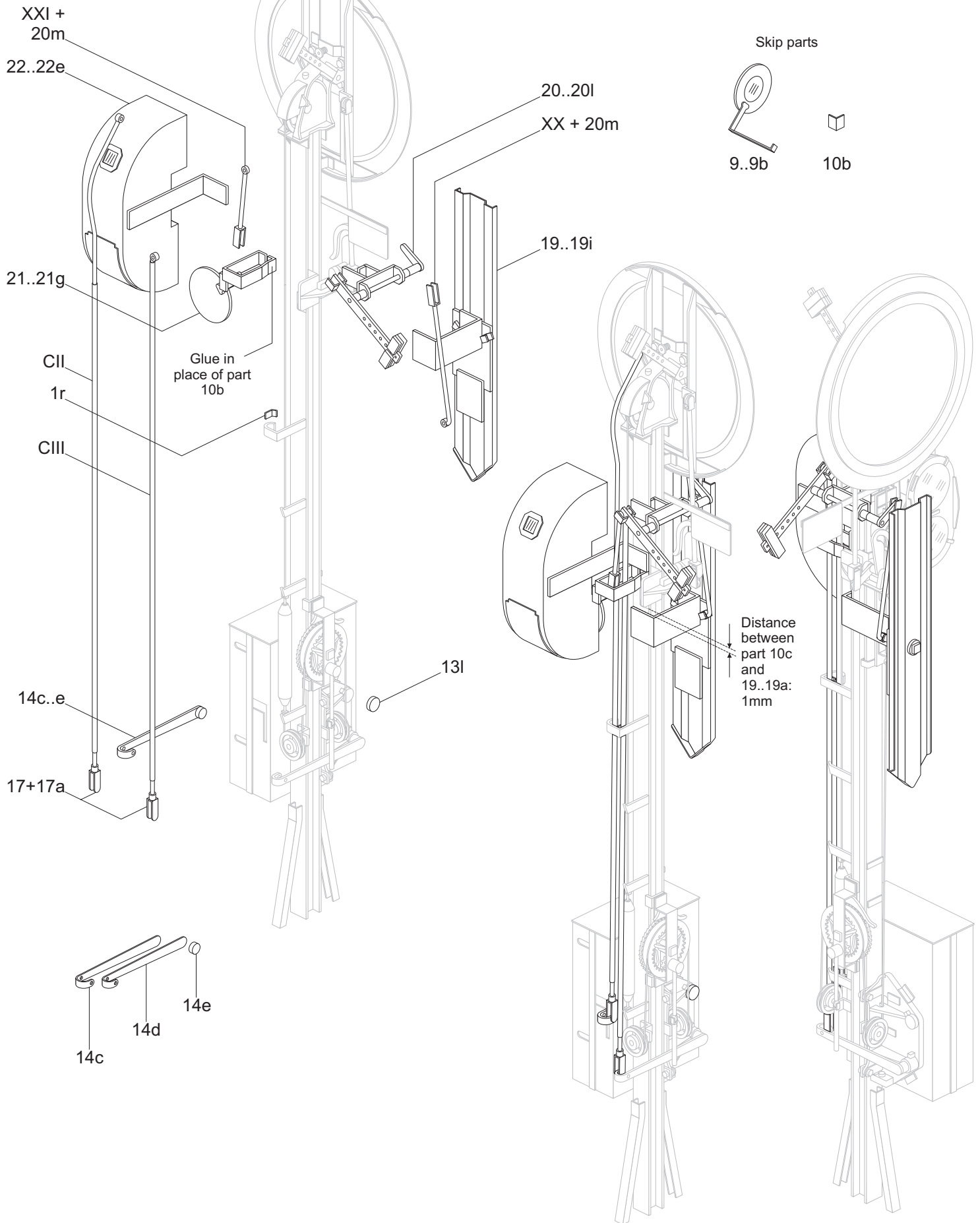

Mechanical distant signal, scale 1:25

Assembly manual 5/8

Signal couplings

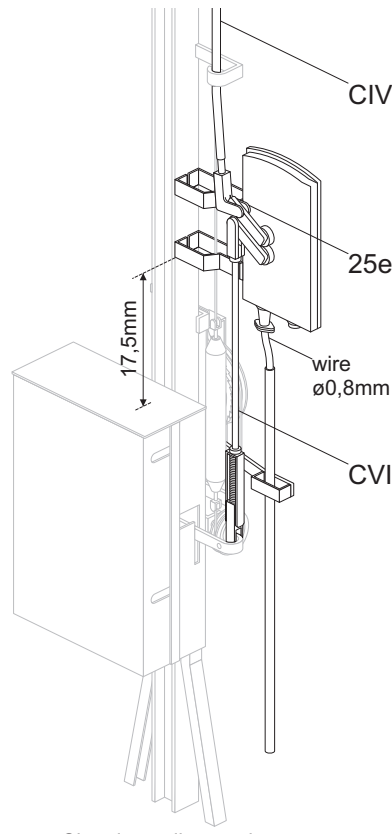
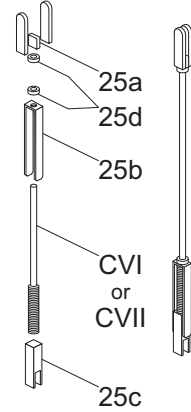
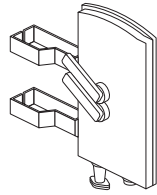
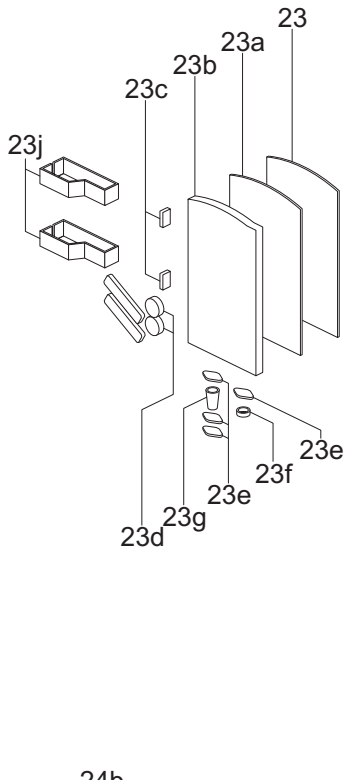

Signal coupling on the two-aspect signal

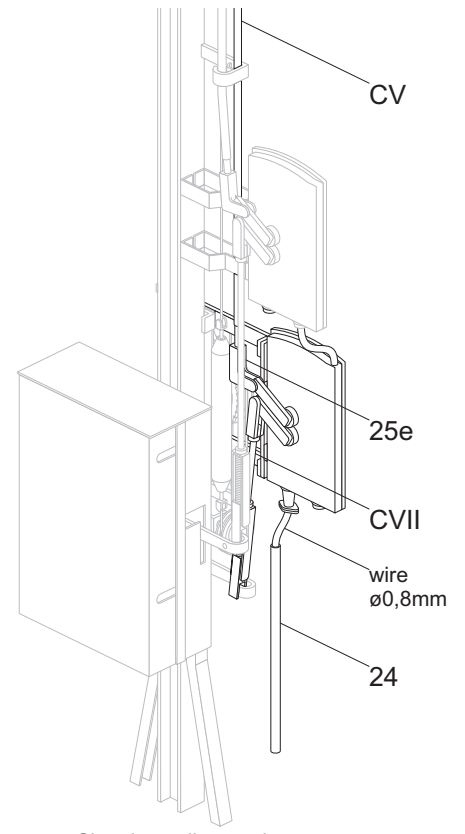

Signal coupling on the three-aspect signal

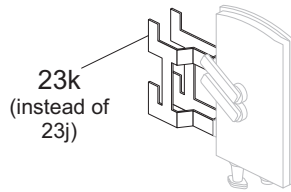
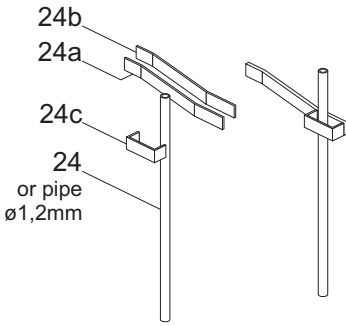

Holder of the upper coupling on the high mast of the signal

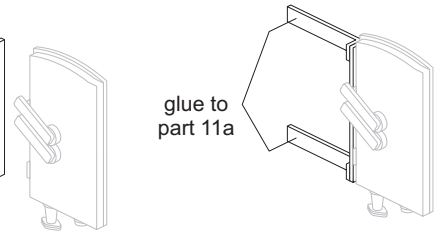
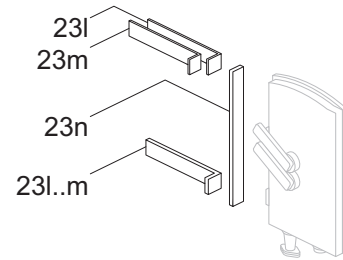

Holder of the lower coupling

Distant signal coupled with the main signal drive

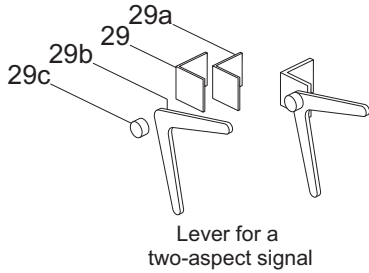

Lever for a two-aspect signal

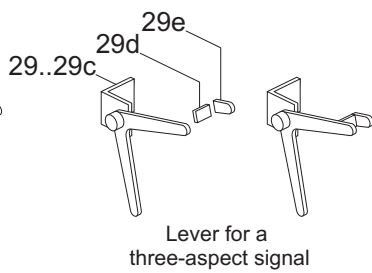

Lever for a three-aspect signal

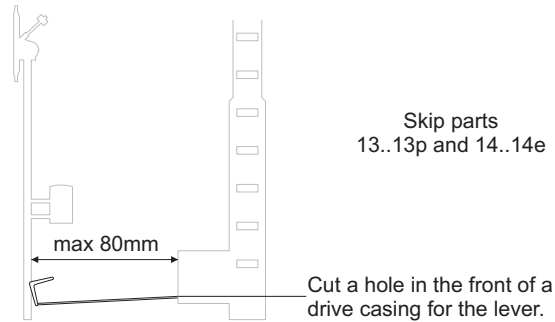

Skip parts 13..13p and 14..14e

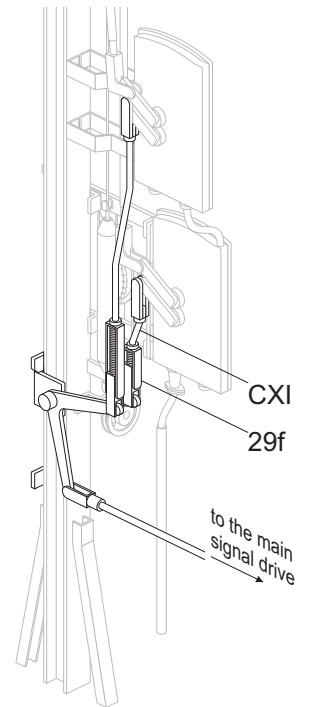
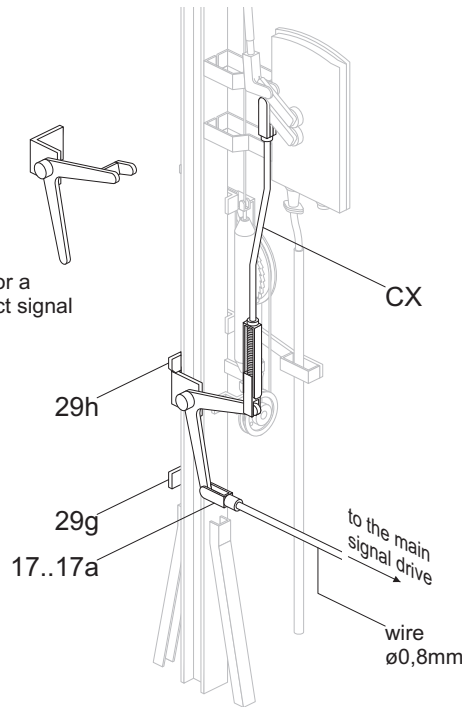

Mechanical distant signal, scale 1:25

Assembly manual 6/8

Electric drive

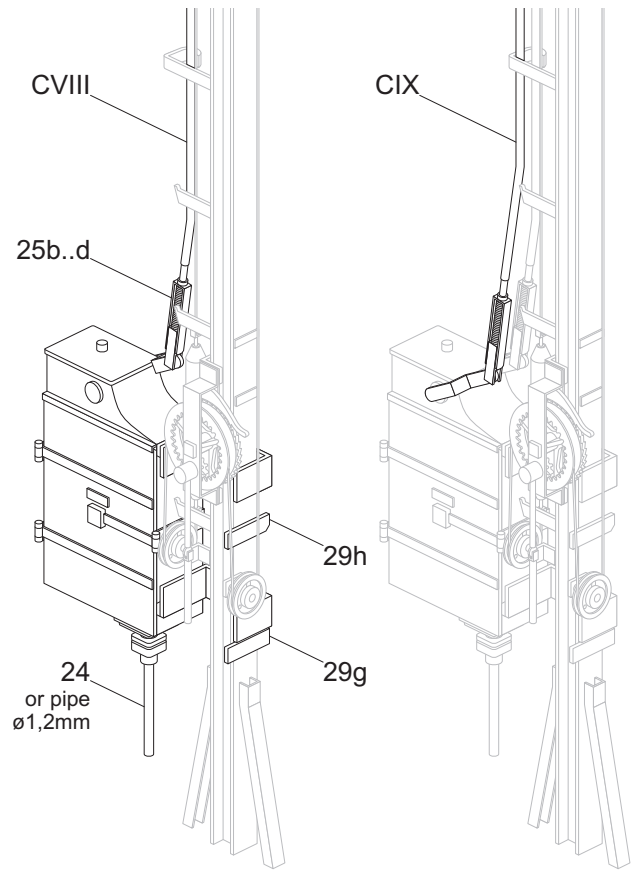
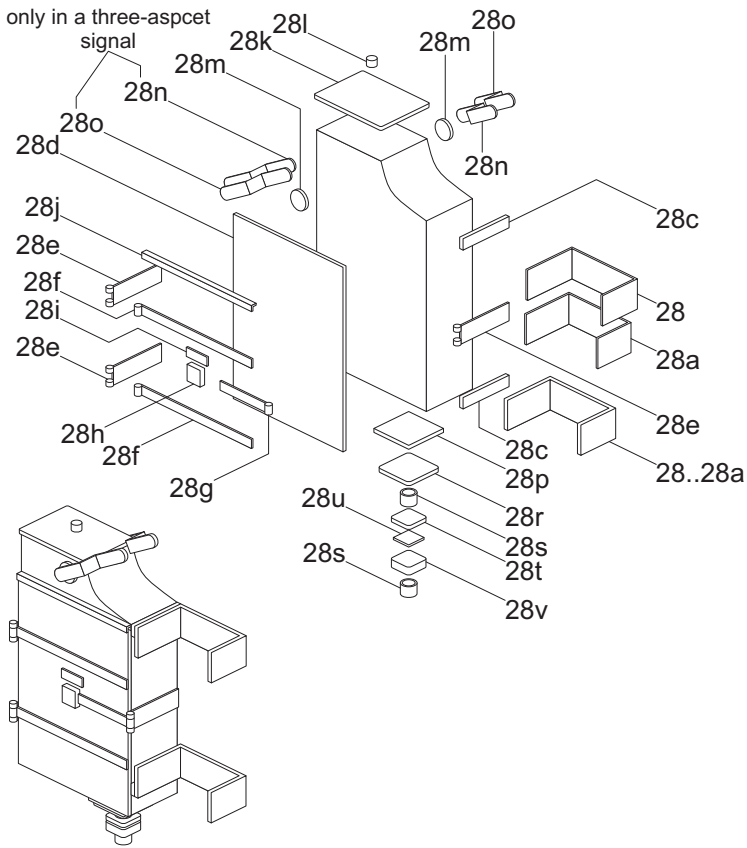

Electric drive in a two-aspect signal

Electric drive in a three-aspect signal

Parts for the signal used before 1959

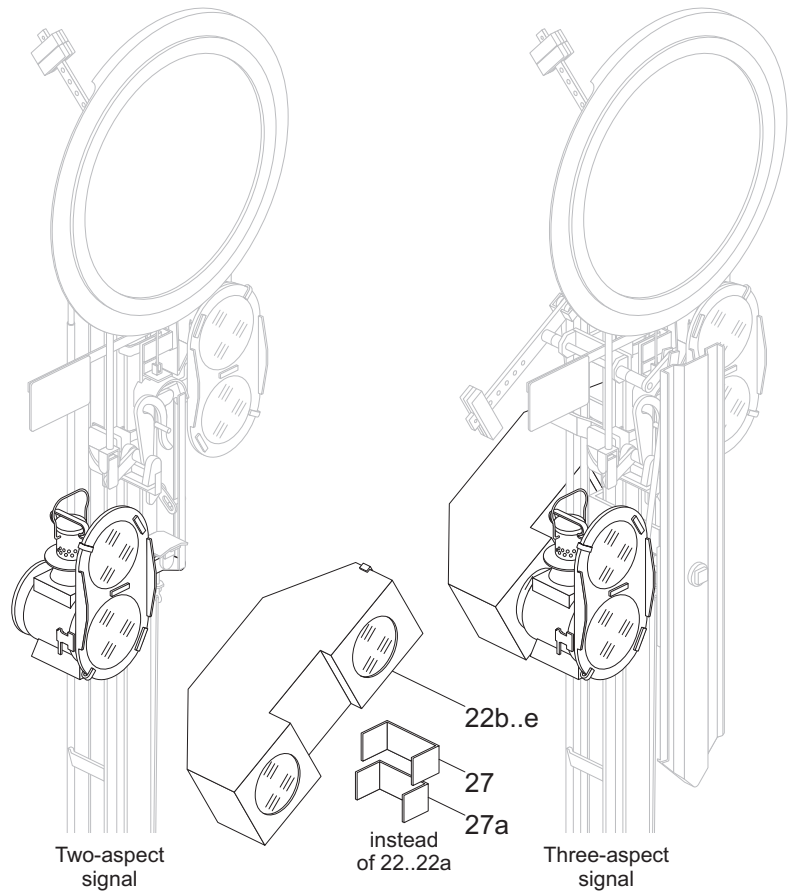
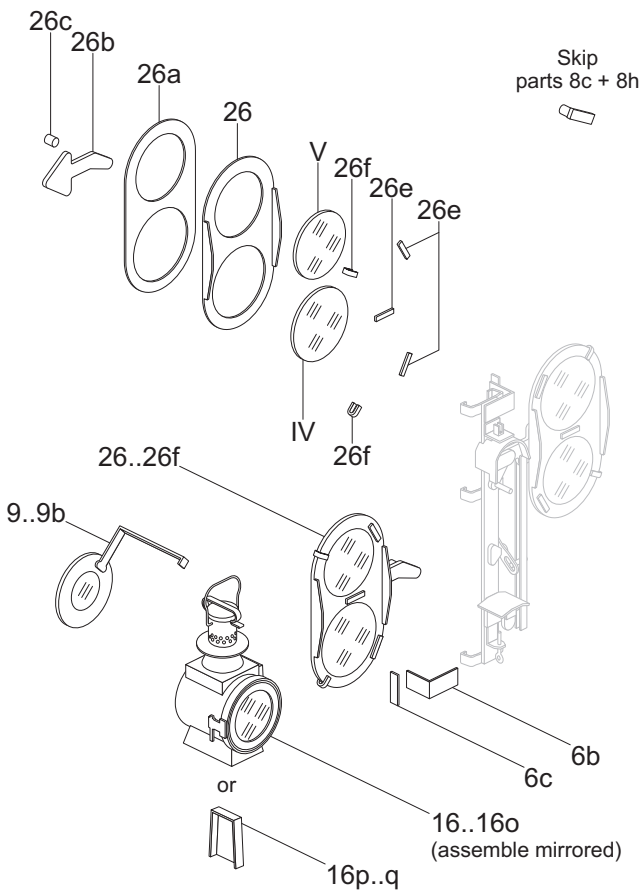

Two-aspect signal

Three-aspect signal

Mechanical distant signal, scale 1:25

Assembly manual 7/8

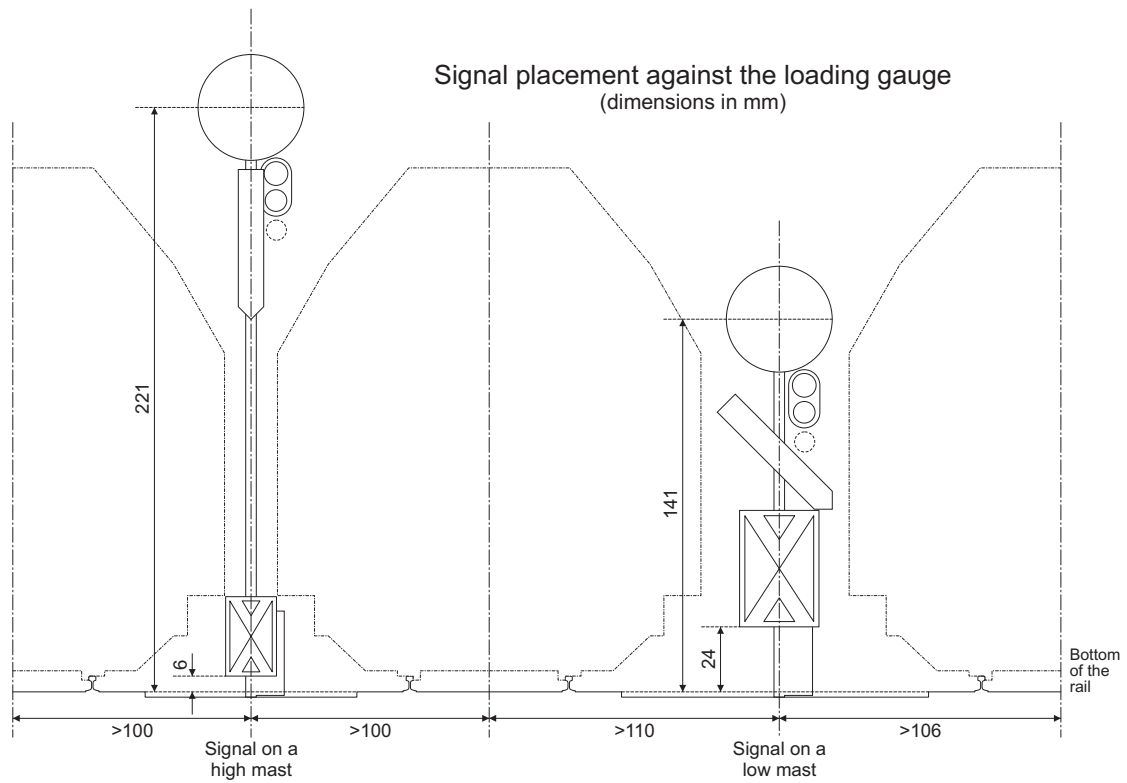
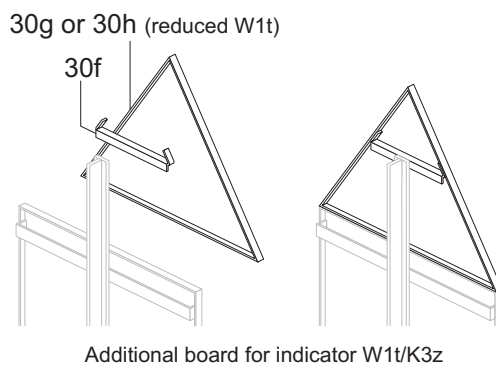
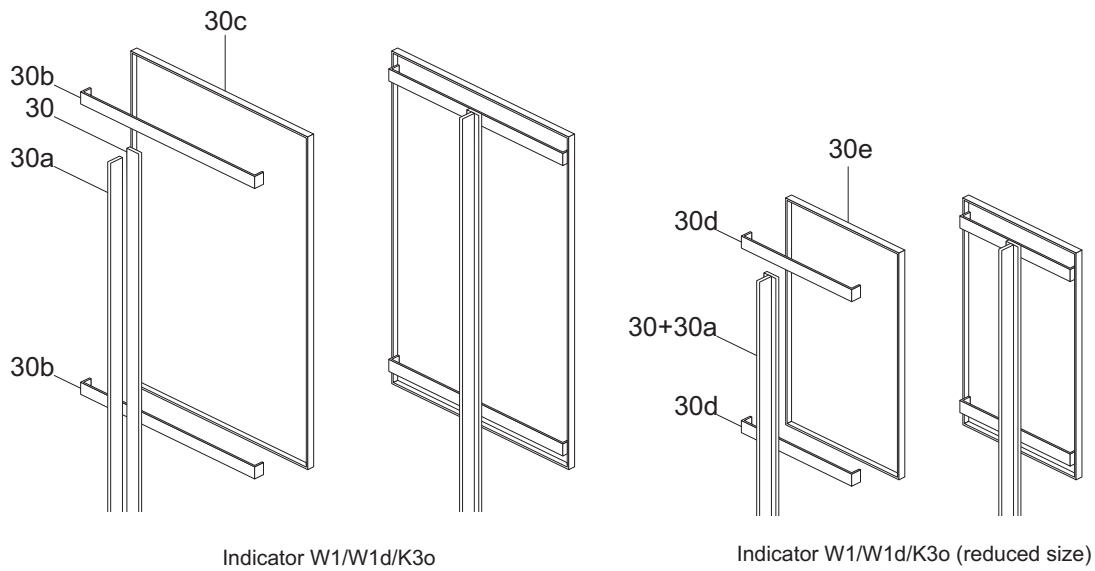

Mechanical distant signal, scale 1:25

Assembly manual 8/8