

Form-Vorsignal, Maßstab 1:25

1cm

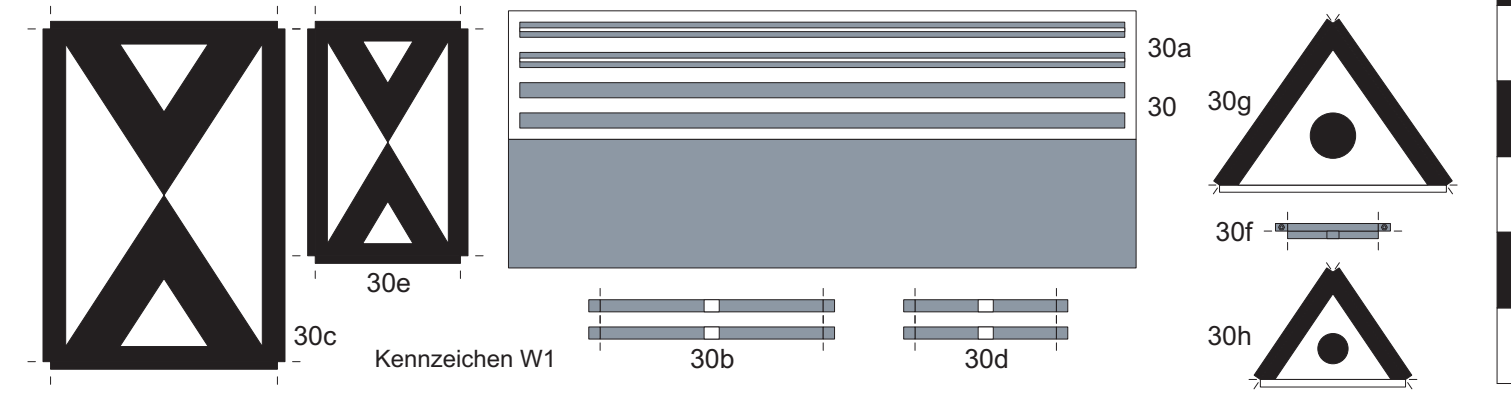
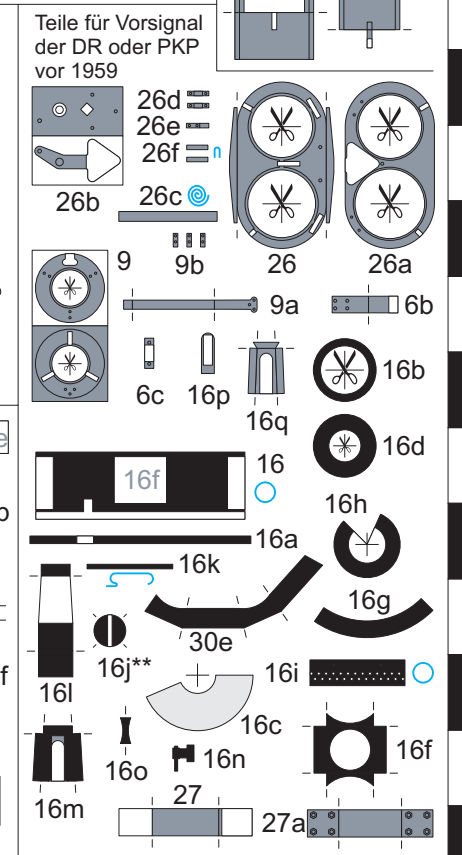
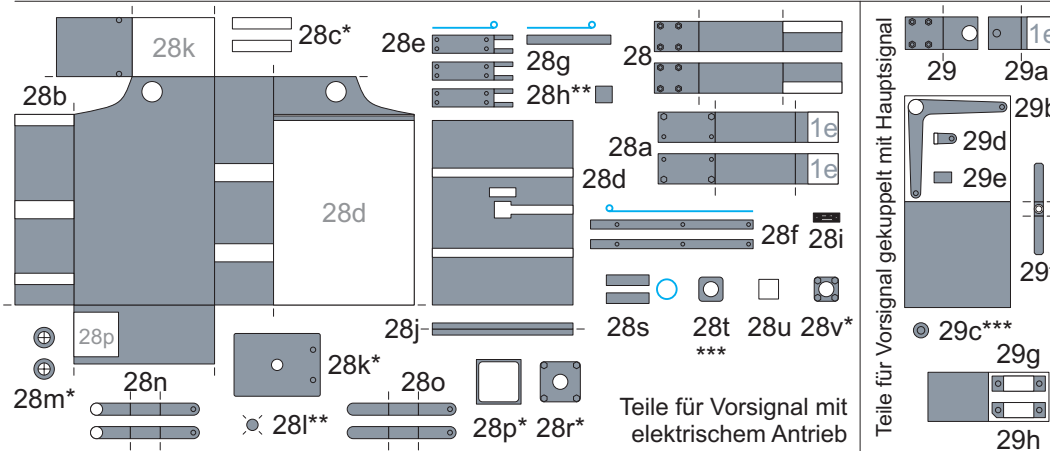
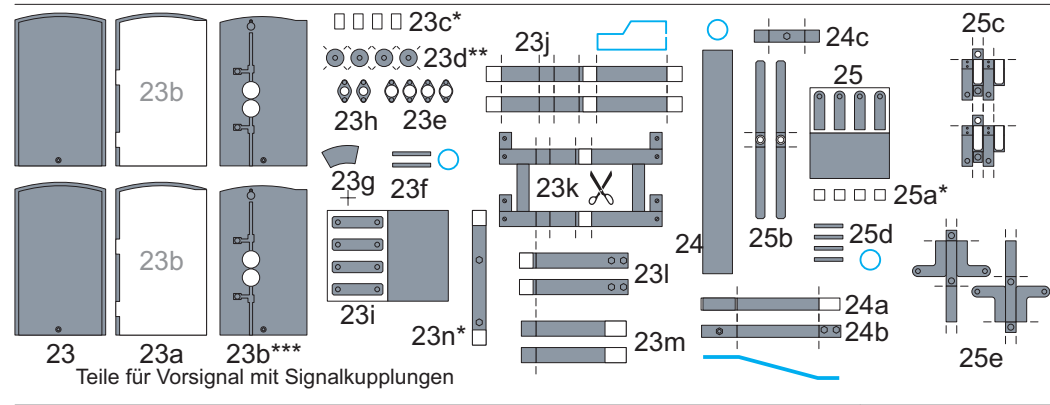
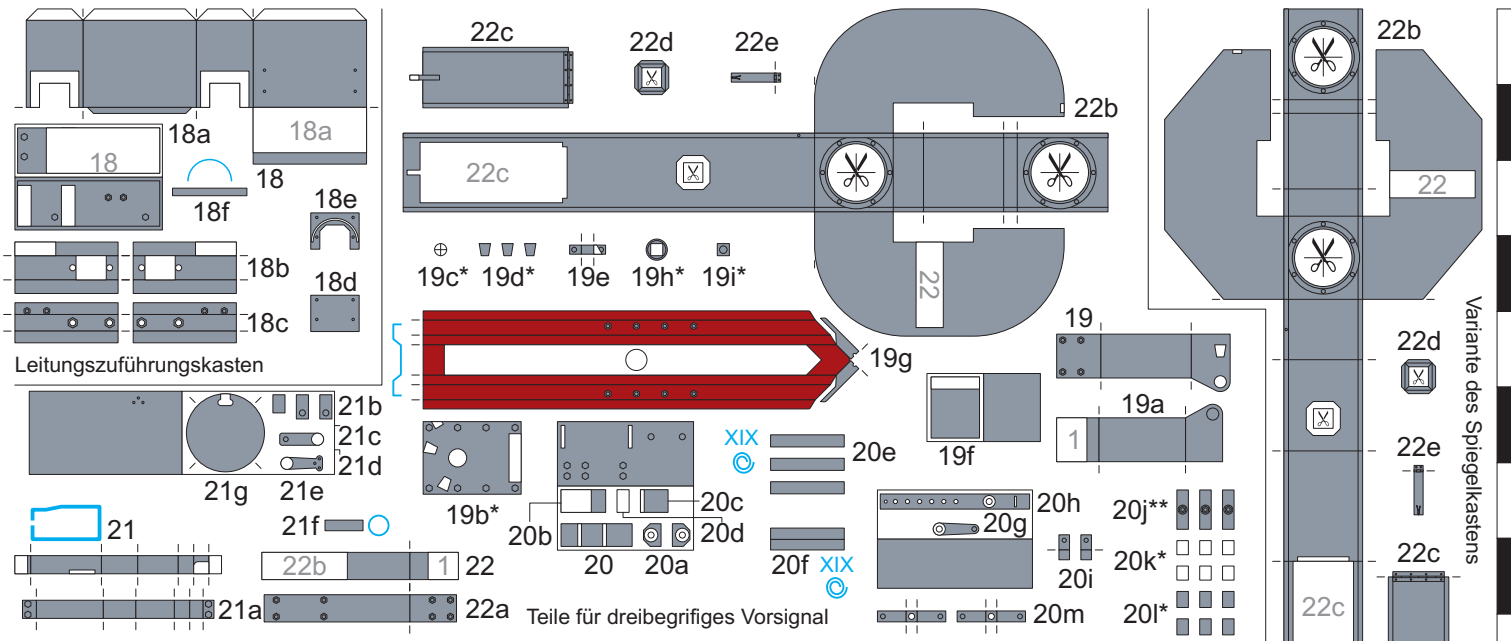

Form-Vorsignal, Maßstab 1:25

Schablone

-  I (Draht)
-  II (Draht)
-  III (Draht)
-  IV (orange Folie)
-  V (grüne Folie)
-  VI (Draht)
-  VII (Draht)
-  VIII (Draht)
-  IX (Draht)
-  X (Draht)
-  XI (Draht)
-  XII (Draht)
-  XIII (weiße Folie)
-  XIV (klare Folie)
-  XV (weiße Folie)
-  XVI (Draht)
-  XVII (Draht)
-  XVIII (Draht)
-  XIX (Draht)
-  XX (Draht)
-  XXI (Draht)
-  XXII (klare Folie)
-  XXIII (grüne Folie)
-  XXIV (weiße Folie)

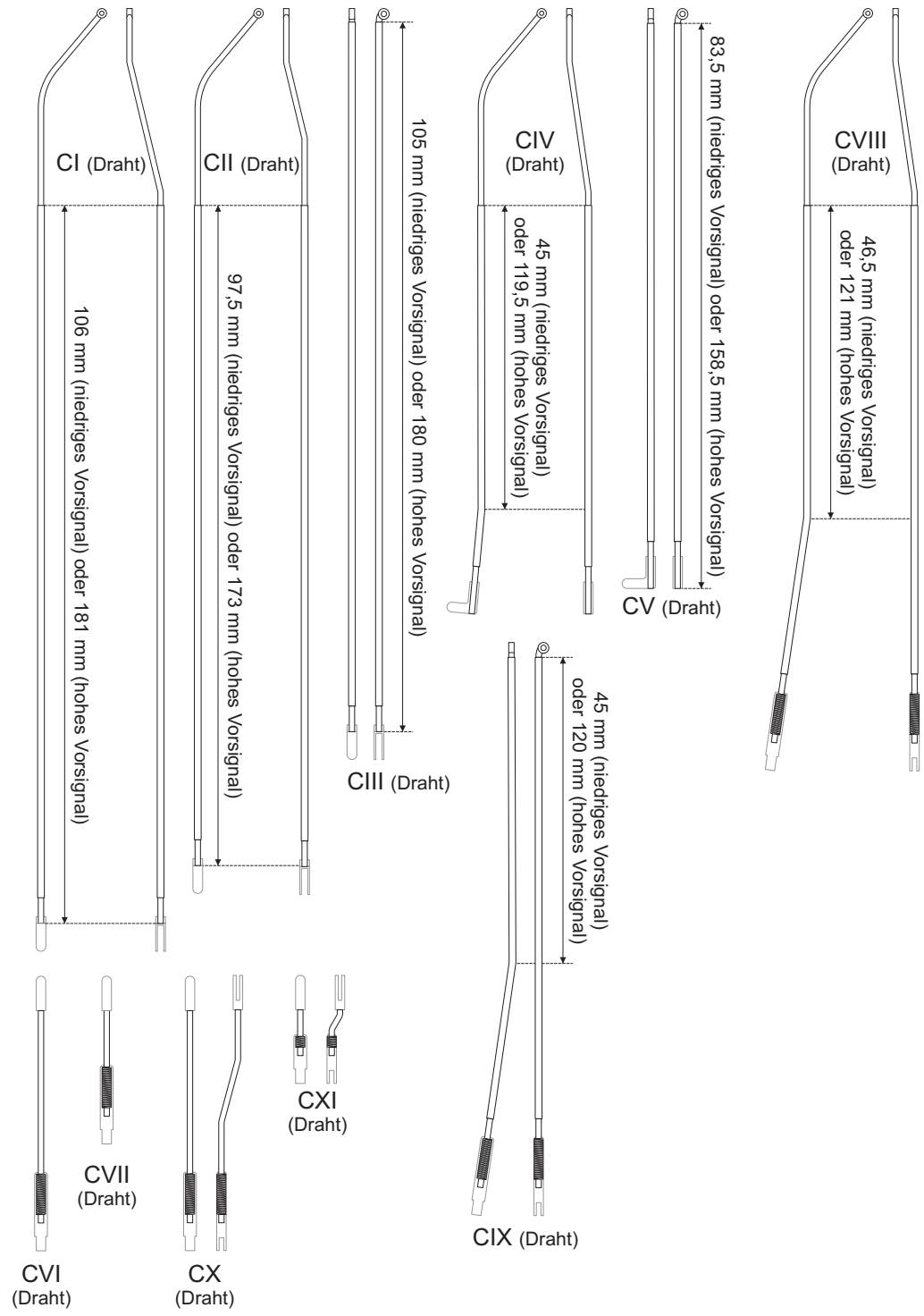

Form-Vorsignal, Maßstab 1:25

1cm

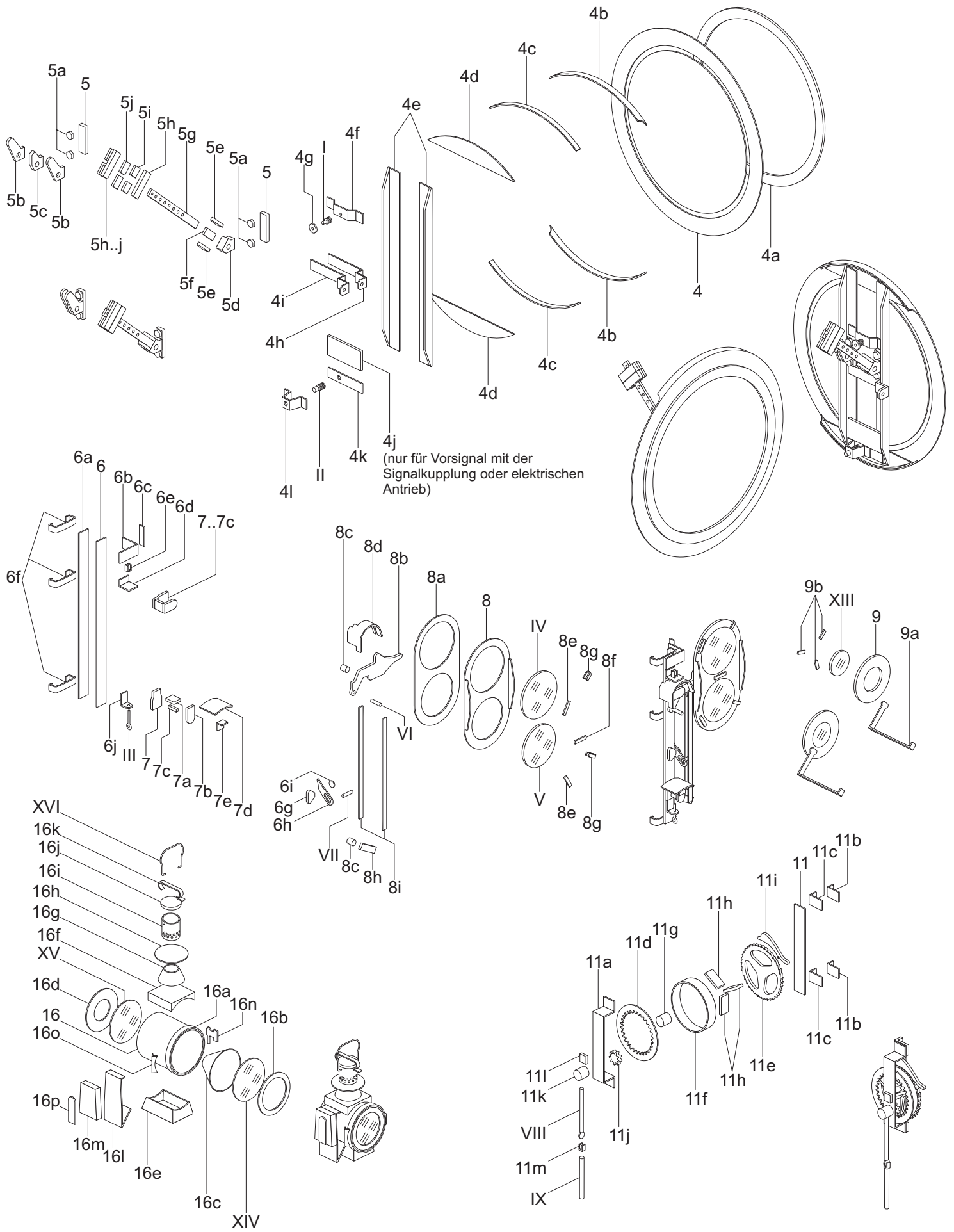

Form-Vorsignal, Maßstab 1:25

Bauanleitung 2/8

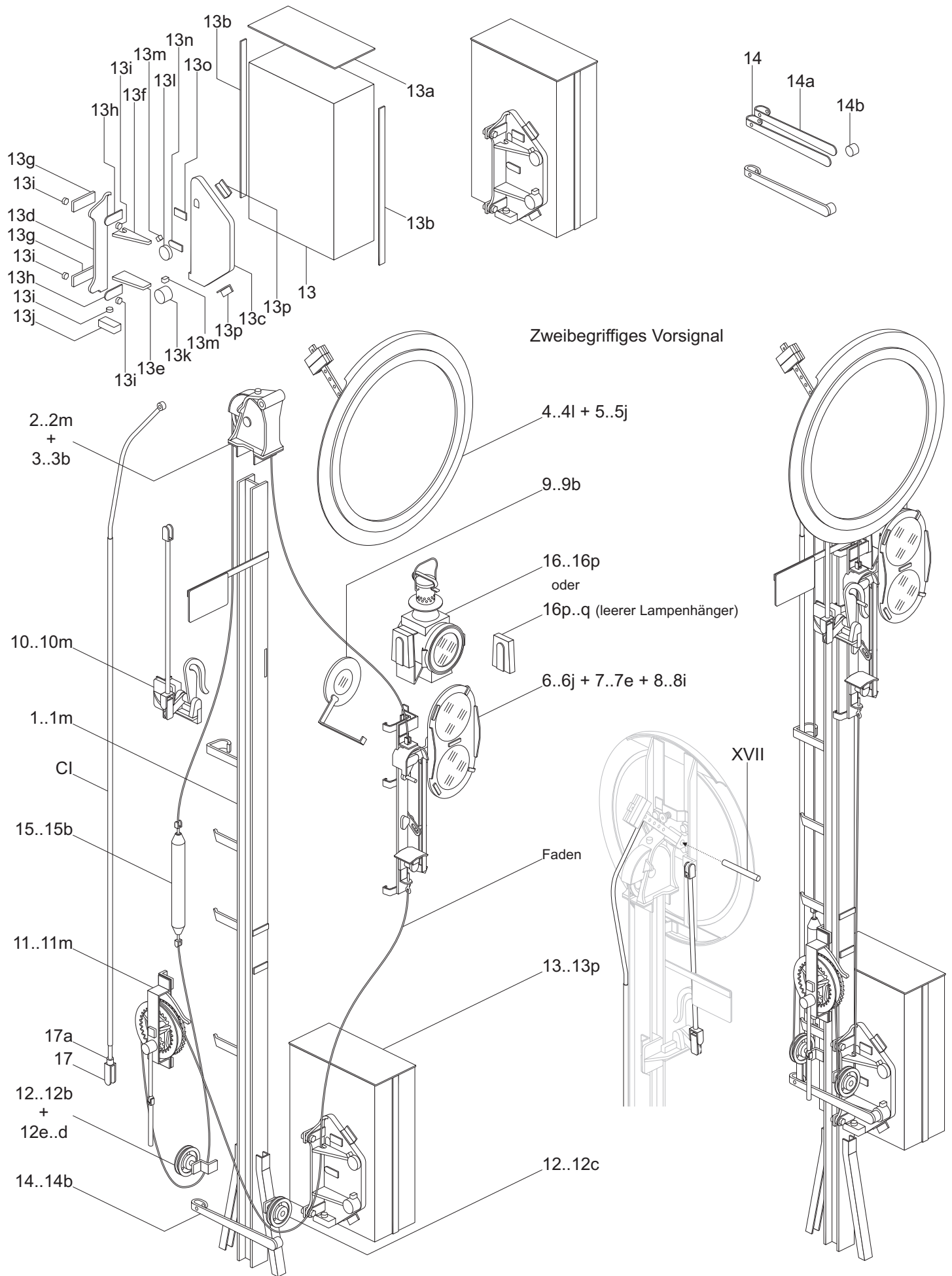

Form-Vorsignal, Maßstab 1:25

Bauanleitung 3/8

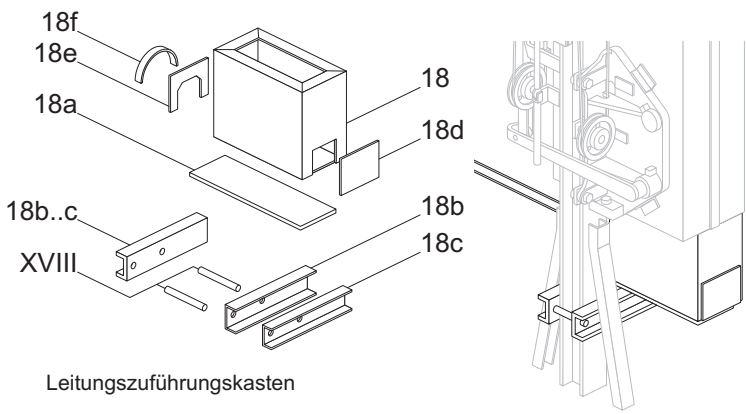

Leitungszuführungskasten

Teile des dreibegriffes Vorsignal

Griff der unbeweglichen Scheibe in zweibegriffes Vorsignal mit beweglichen Flügel.

In diesem Variante auslassen Teile 10..10m und grüne Signalblende (Teil V).

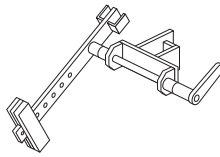
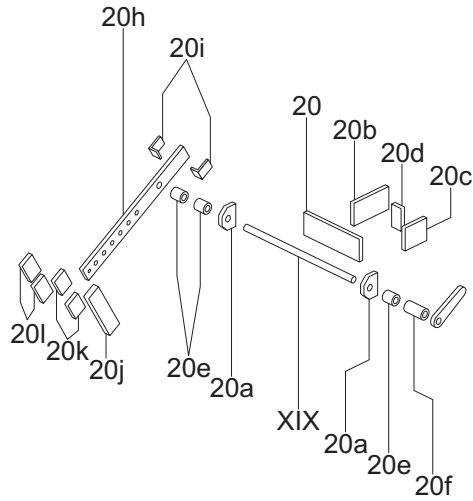
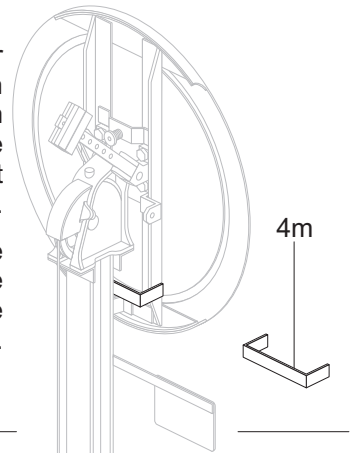

Gegengewichte für Vorsignal mit Signalkupplung

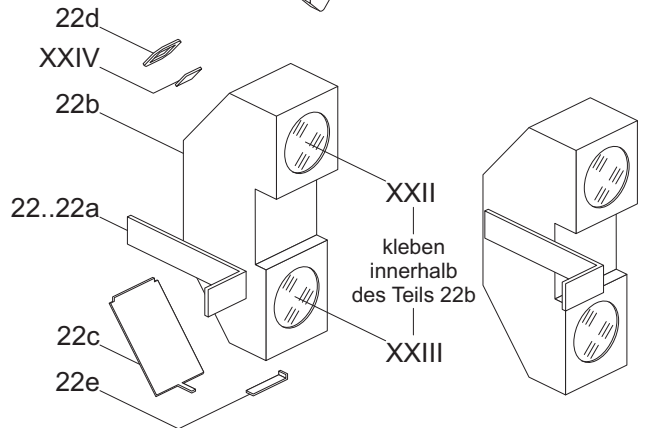
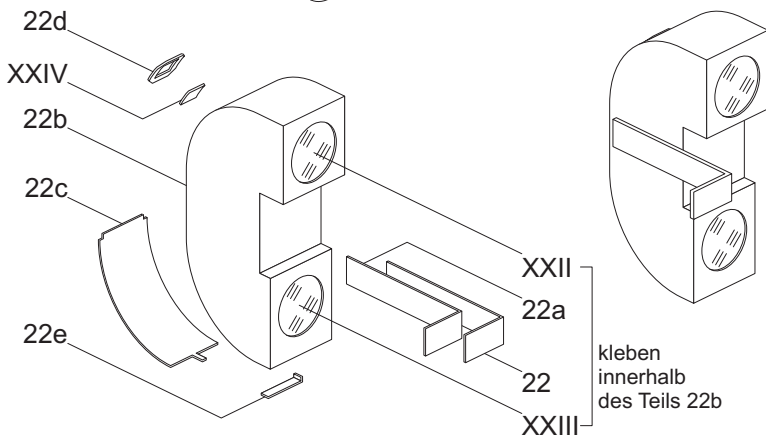
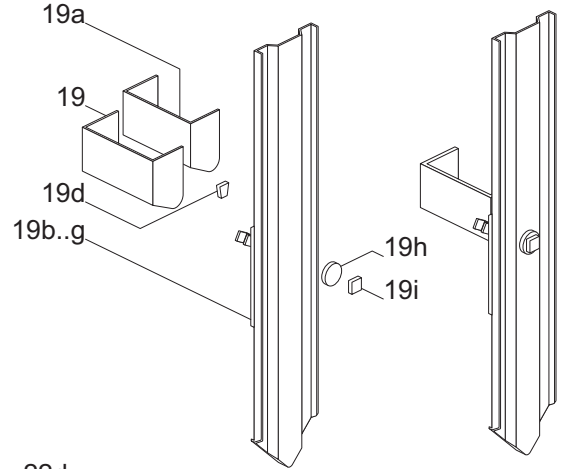
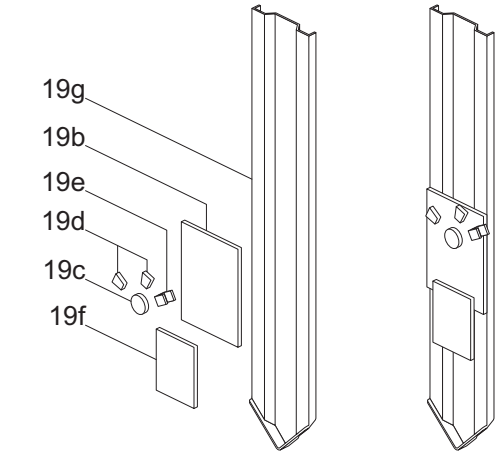
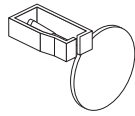
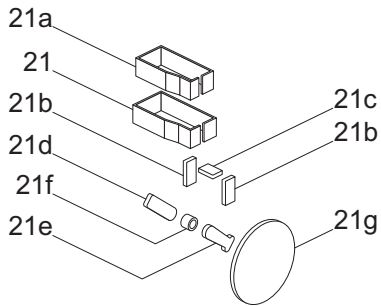

Variante des Spiegelkastens

Form-Vorsignal, Maßstab 1:25

Bauanleitung 4/8

Dreibegriffiges Vorsignal

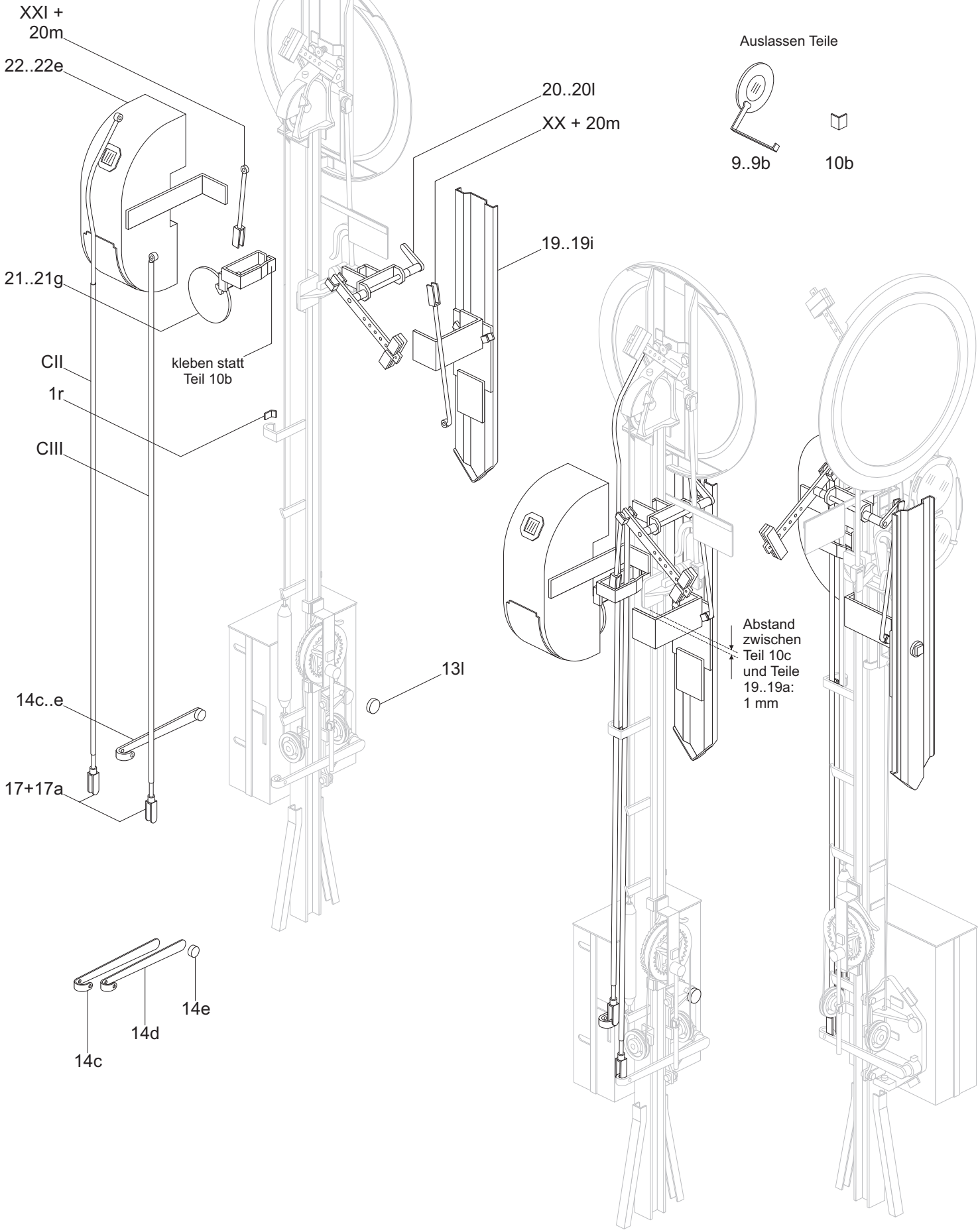

Form-Vorsignal, Maßstab 1:25

Bauanleitung 5/8

Signalkupplungen

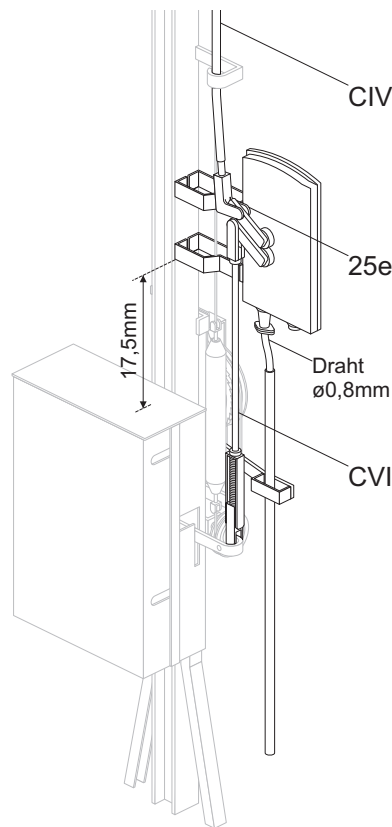
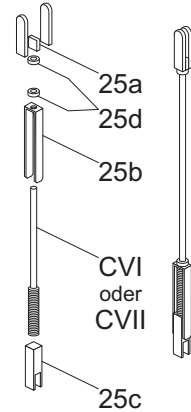
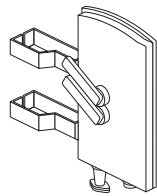
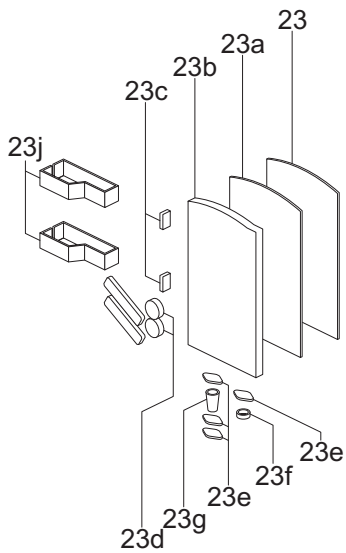

Signalkupplung für zweibegriffes Vorsignal

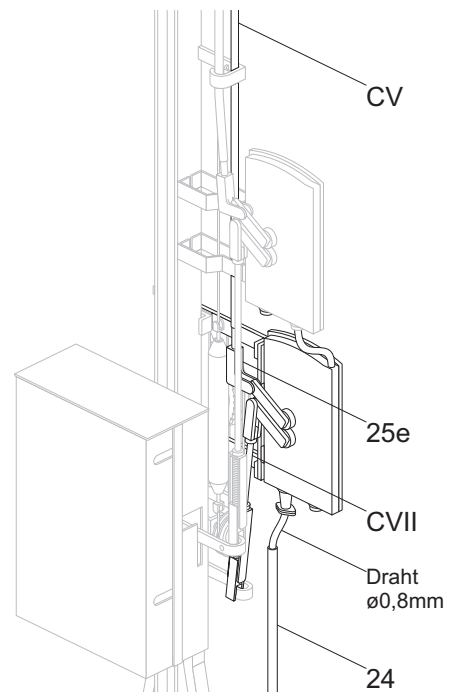

Signalkupplung für dreibegriffes Vorsignal

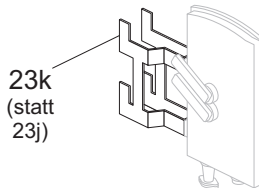
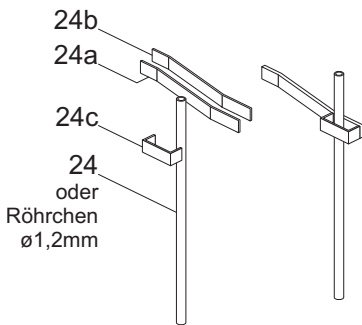

Befestigung der oberen Signalkupplung

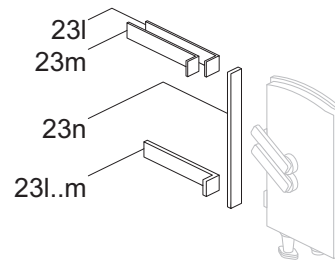

Befestigung der unterer Signalkupplung

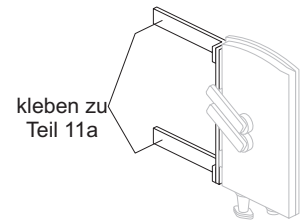

Kupplung mit Hauptsignalantrieb

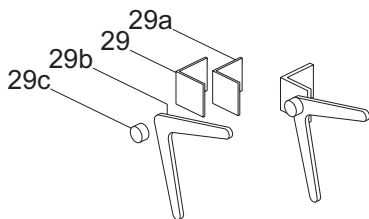

Hebel für zweibegriffes Vorsignal

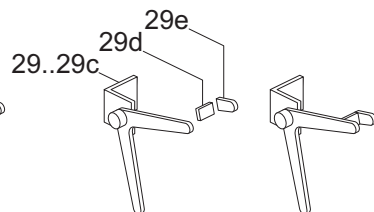

Hebel für dreibegriffes Vorsignal

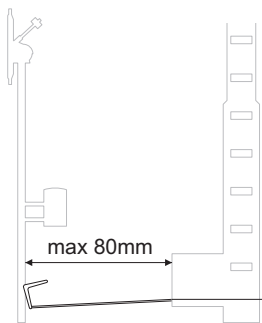

Auslassen Teile 13..13p i 14..14e

Auschneiden ein Loch für die Zugstange.

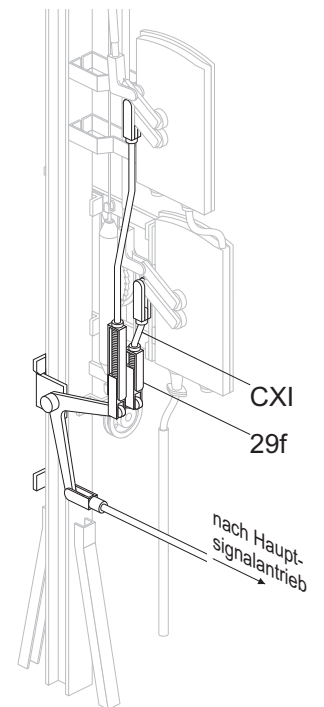
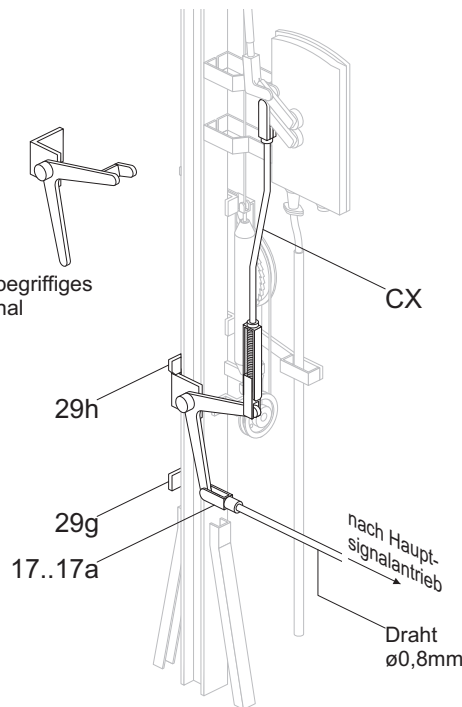

Form-Vorsignal, Maßstab 1:25

Bauanleitung 6/8

Elektrischer Antrieb

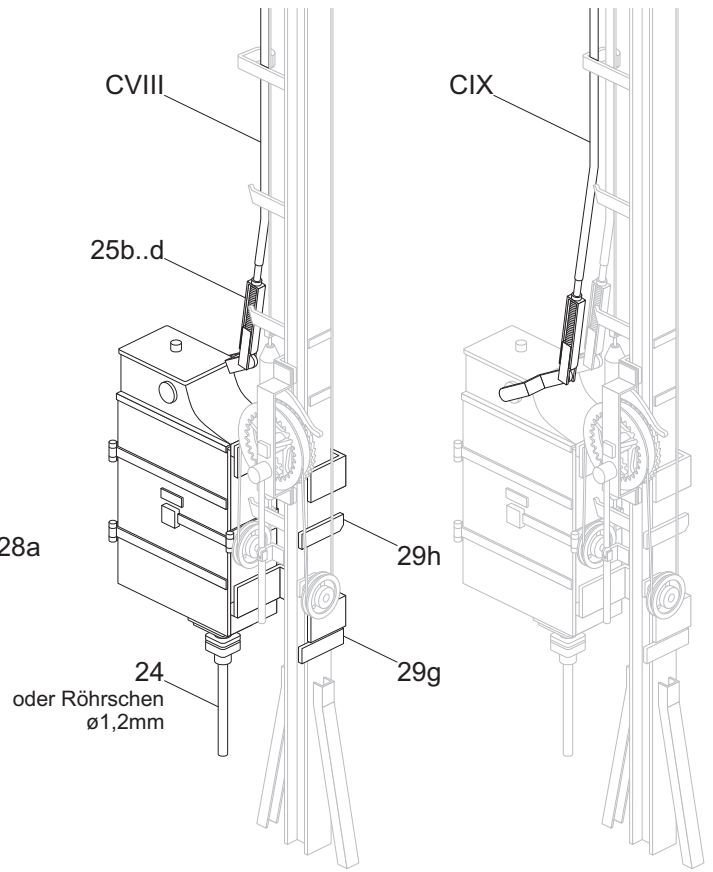
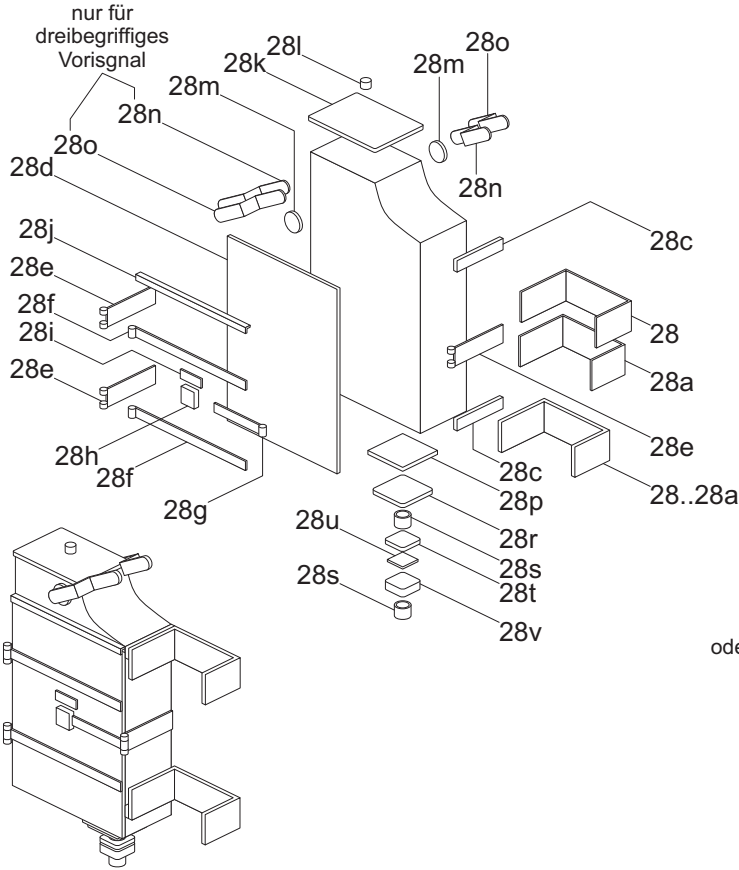

Elektrischer Antrieb für zweibegriffiges Vorsignal

Elektrischer Antrieb für dreibegriffiges Vorsignal

Vorsignal der DR oder PKP vor 1959

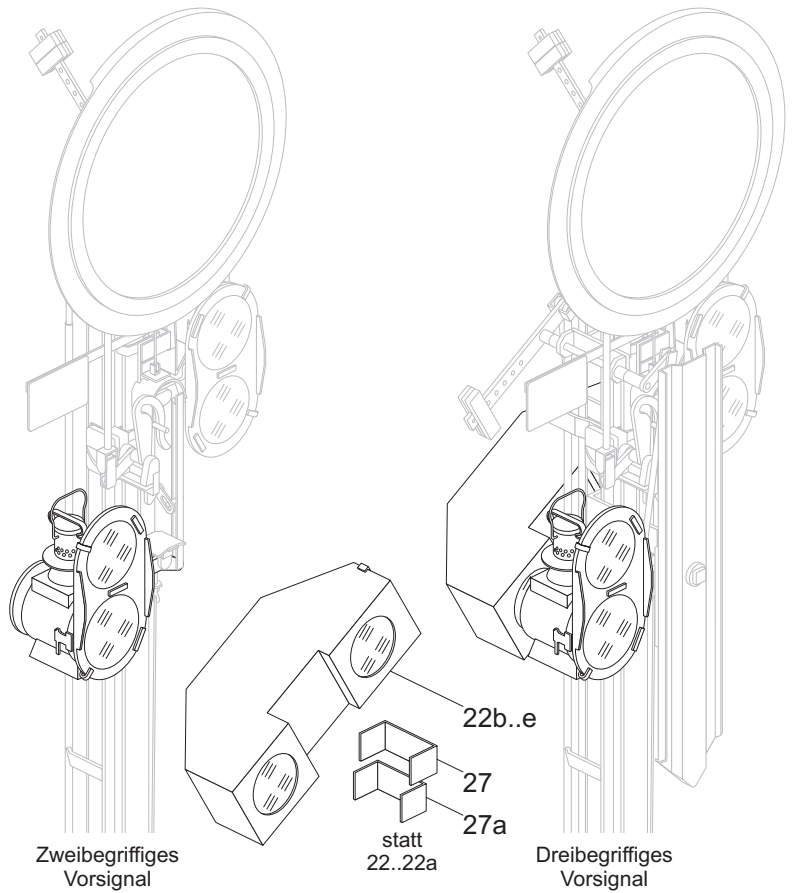
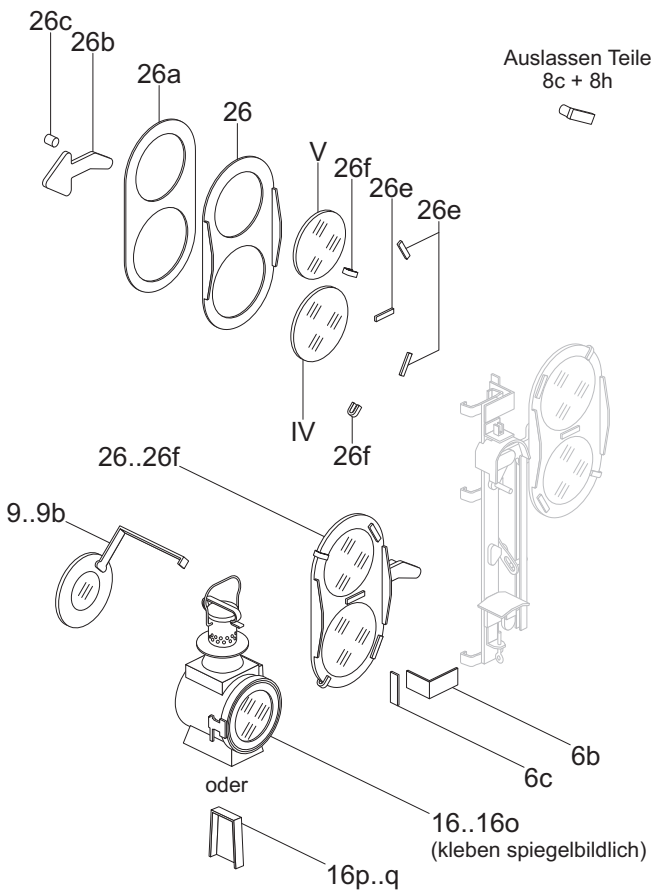

Zweibegriffiges Vorsignal

Dreibegriffiges Vorsignal

Form-Vorsignal, Maßstab 1:25

Bauanleitung 7/8

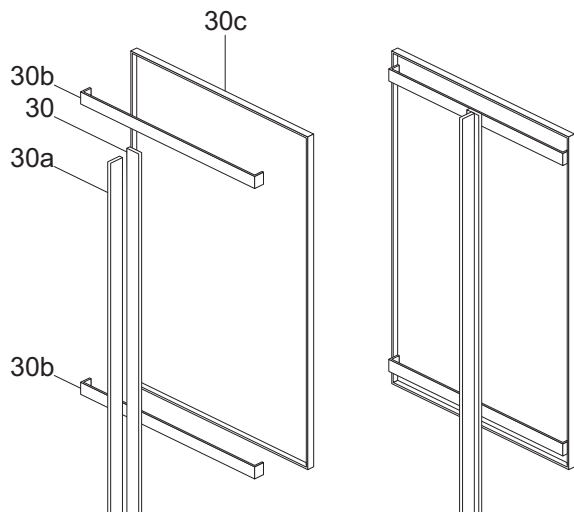

Kennzeichen W1/W1d/K3o

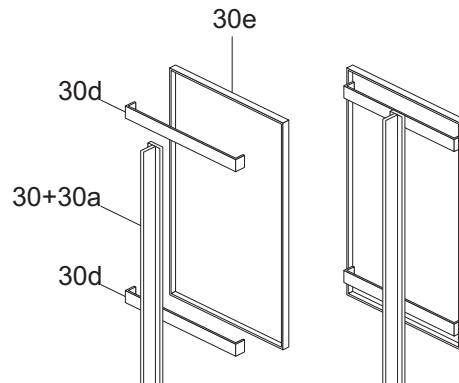

Kennzeichen W1/W1d/K3o (niedriges)

30g oder 30h (niedriges K3z)

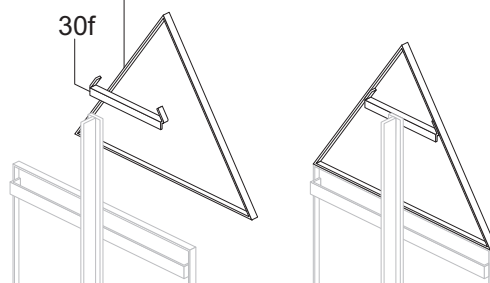

Zusatztafel für Kennzeichen W1t/K3z

Lage von Signal gegenüber dem Lademaß
(Ausmaße in mm)

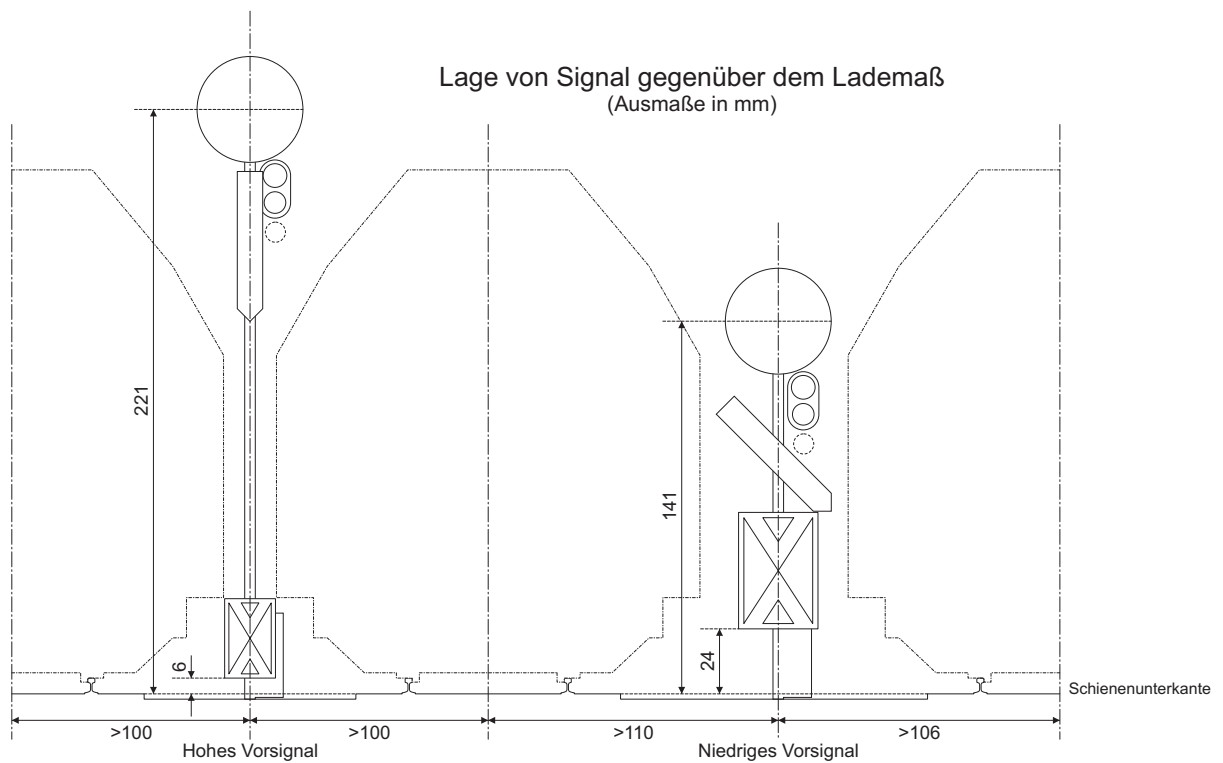

Form-Vorsignal, Maßstab 1:25

Bauanleitung 8/8