

Parts for 3D printing

all parts to be printed out of PETG or PLA
part colour provided next to the part number

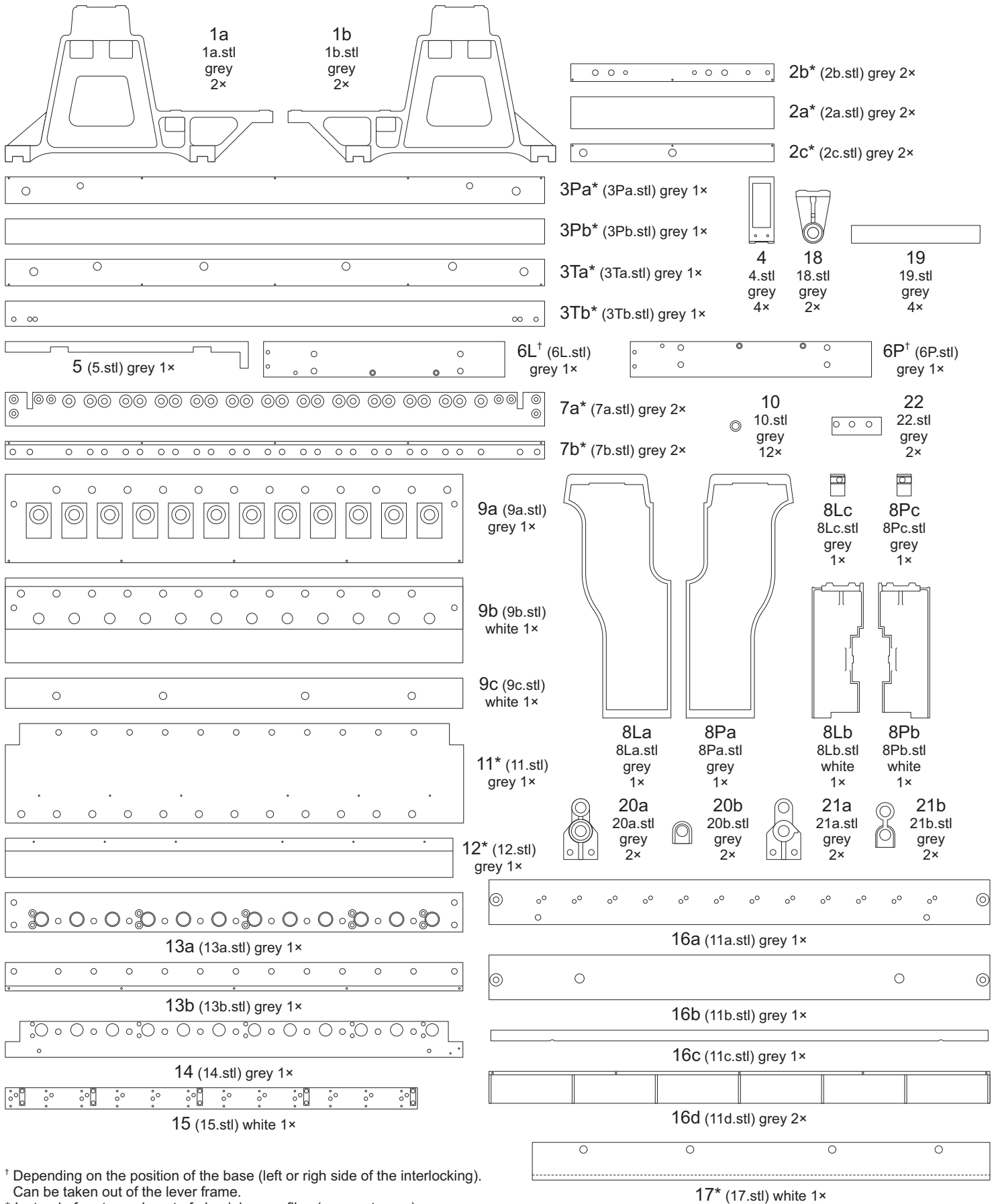

† Depending on the position of the base (left or right side of the interlocking).
Can be taken out of the lever frame.

* Instead of parts made out of aluminium profiles (see next page).

Block instrument base, scale 1:5

List of 3D printed parts

Other required parts

Drill the holes after glueing on the templates, see page 3 of the manual

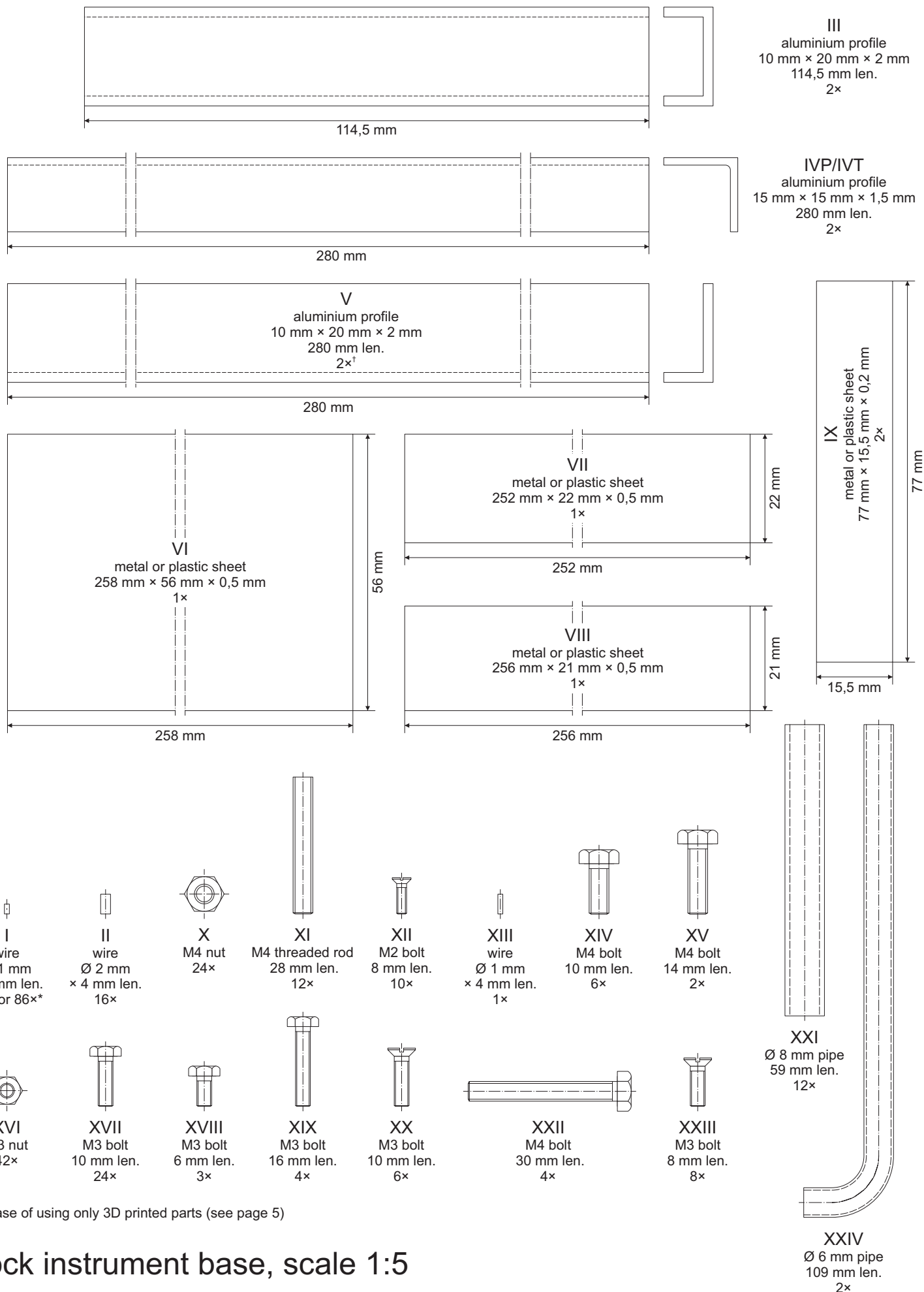

* In case of using only 3D printed parts (see page 5)

Block instrument base, scale 1:5

List of other required parts

Author: Paweł Adamowicz (<http://pkprepo.net/>), 2025-2026, selected rights reserved

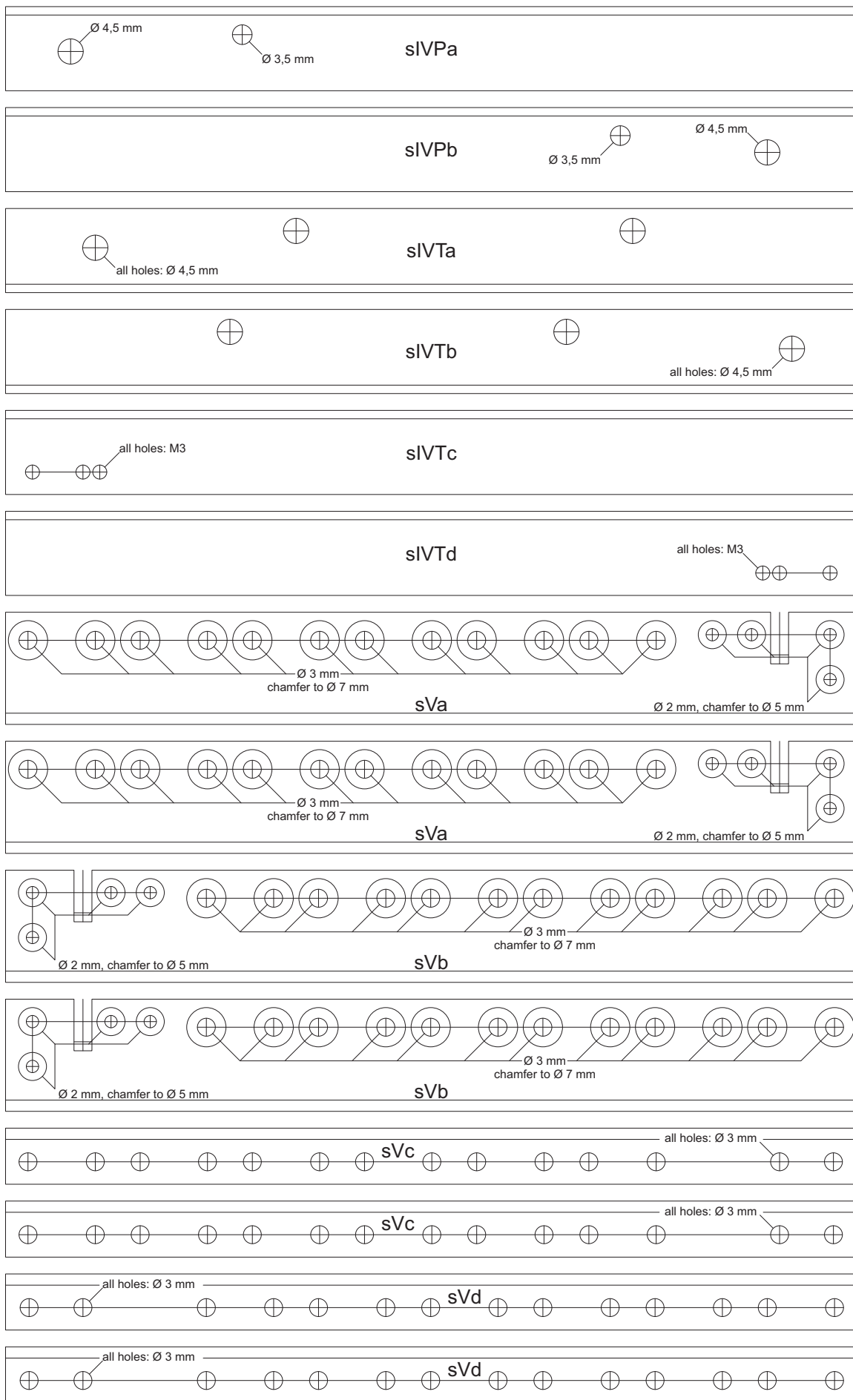

Block instrument base, scale 1:5

Drilling templates 1/2

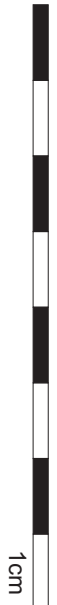
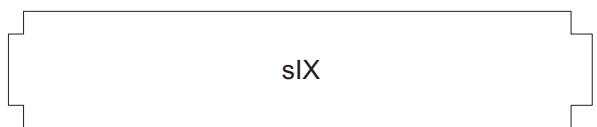
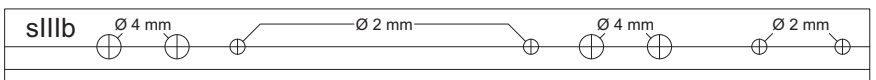
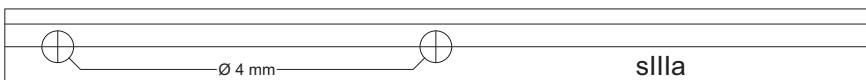
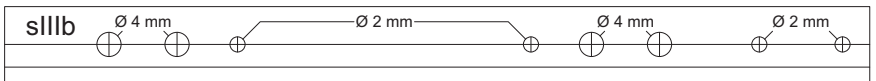
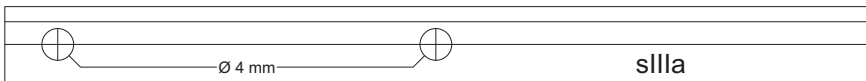
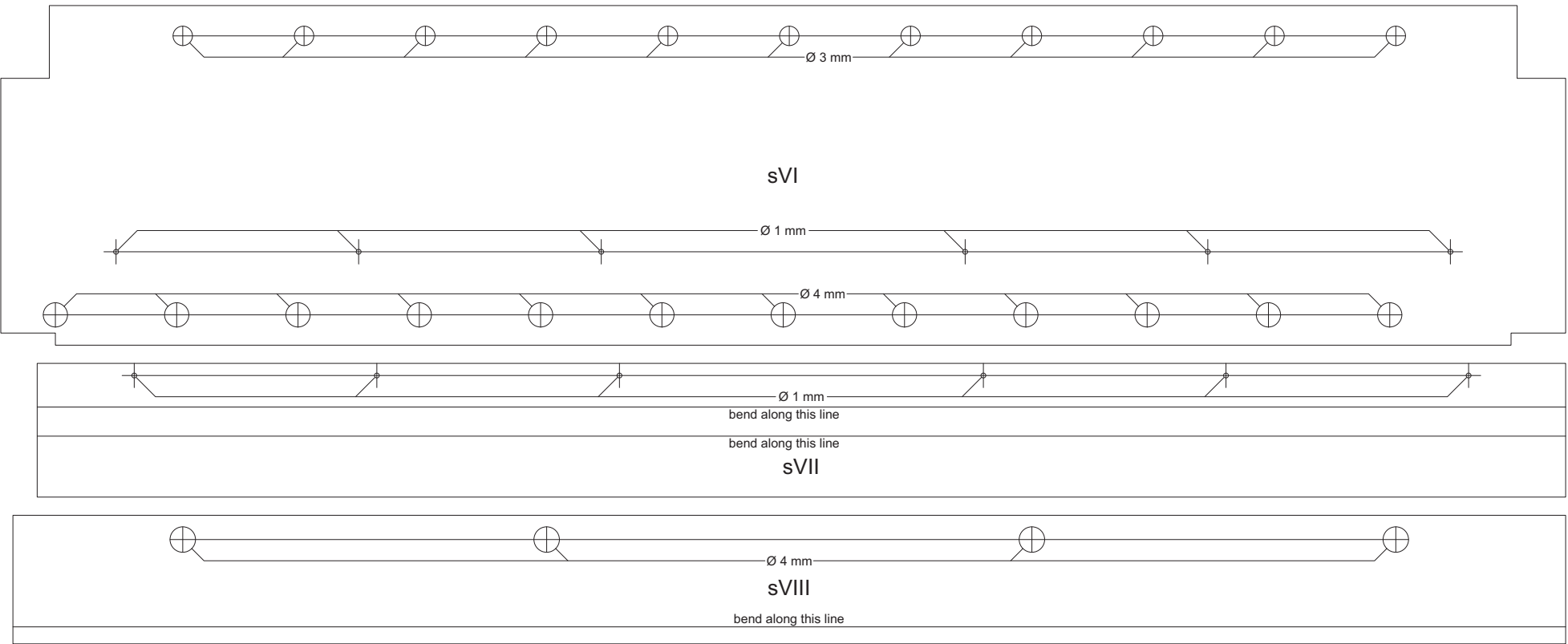

Block instrument base, scale 1:5

Drilling templates 2/2



Preparation of the lever frame

Case of a block instrument base situated on the right of the interlocking is shown.
In case of the base on the left side, replace respective parts from the left side of the lever frame.

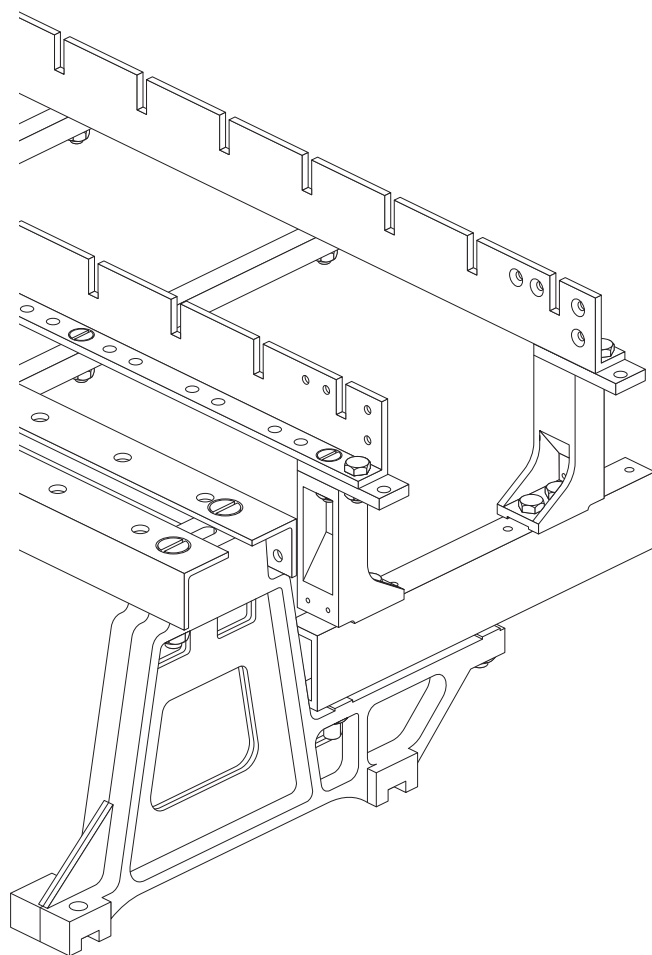
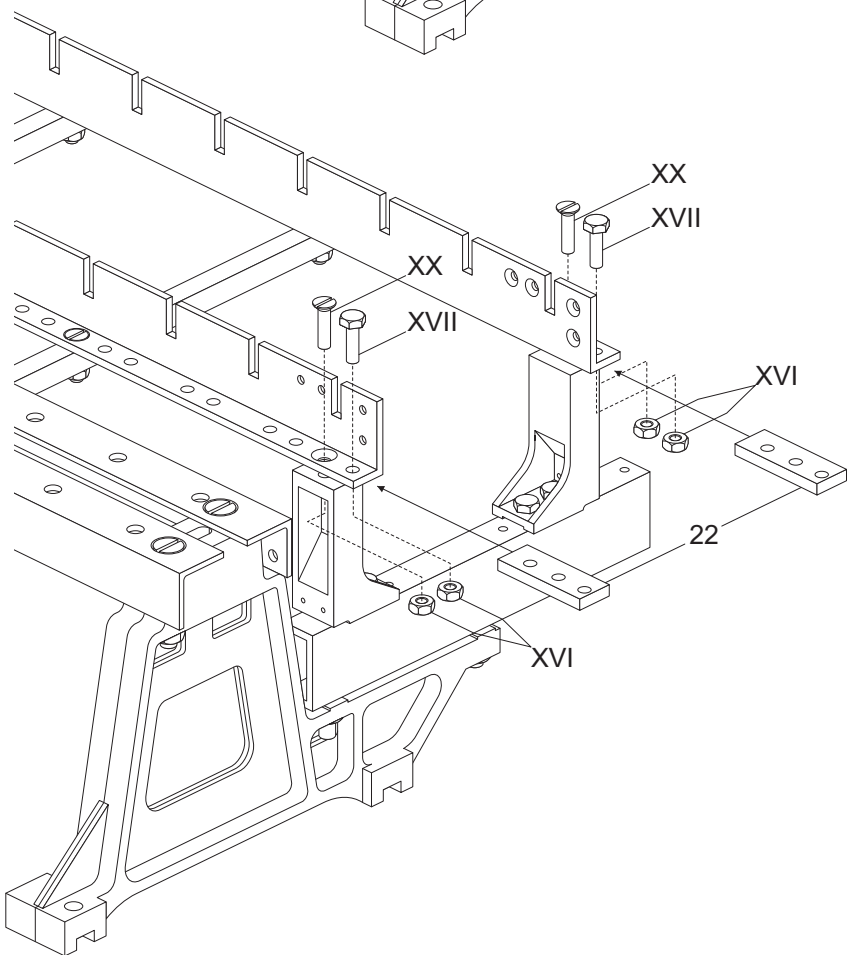
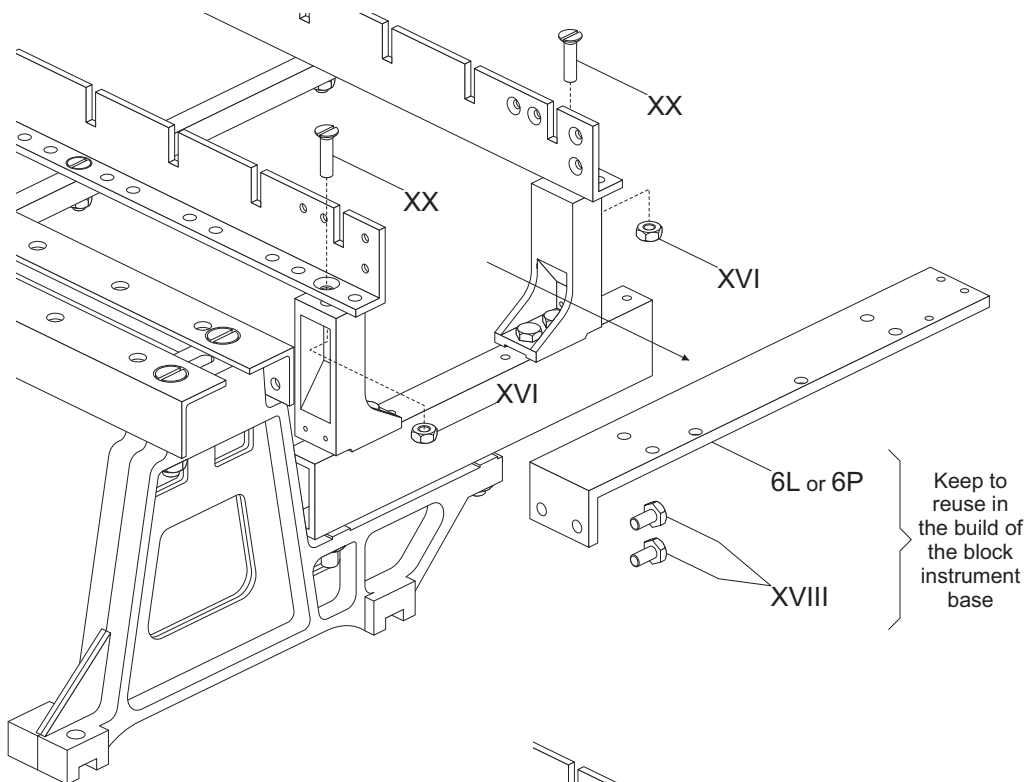

Block instrument base, scale 1:5

Assembly manual 1/16

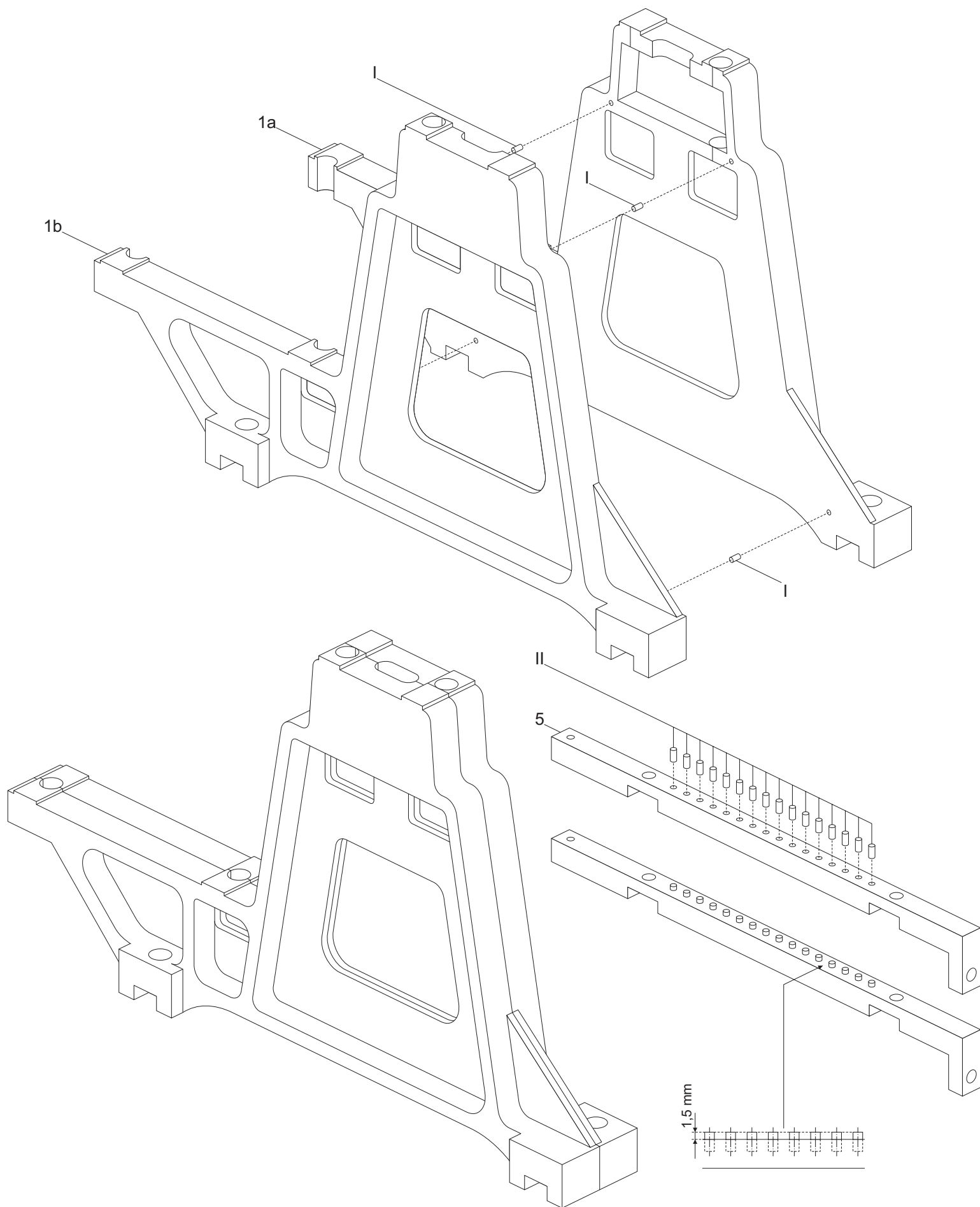

Block instrument base, scale 1:5

Assembly manual 2/16

Longerons of the base
(variant made out of aluminium profiles)
Applying the drilling templates

Attention!
Templates should not be glued on permanently
(use eg. water-soluble glue).

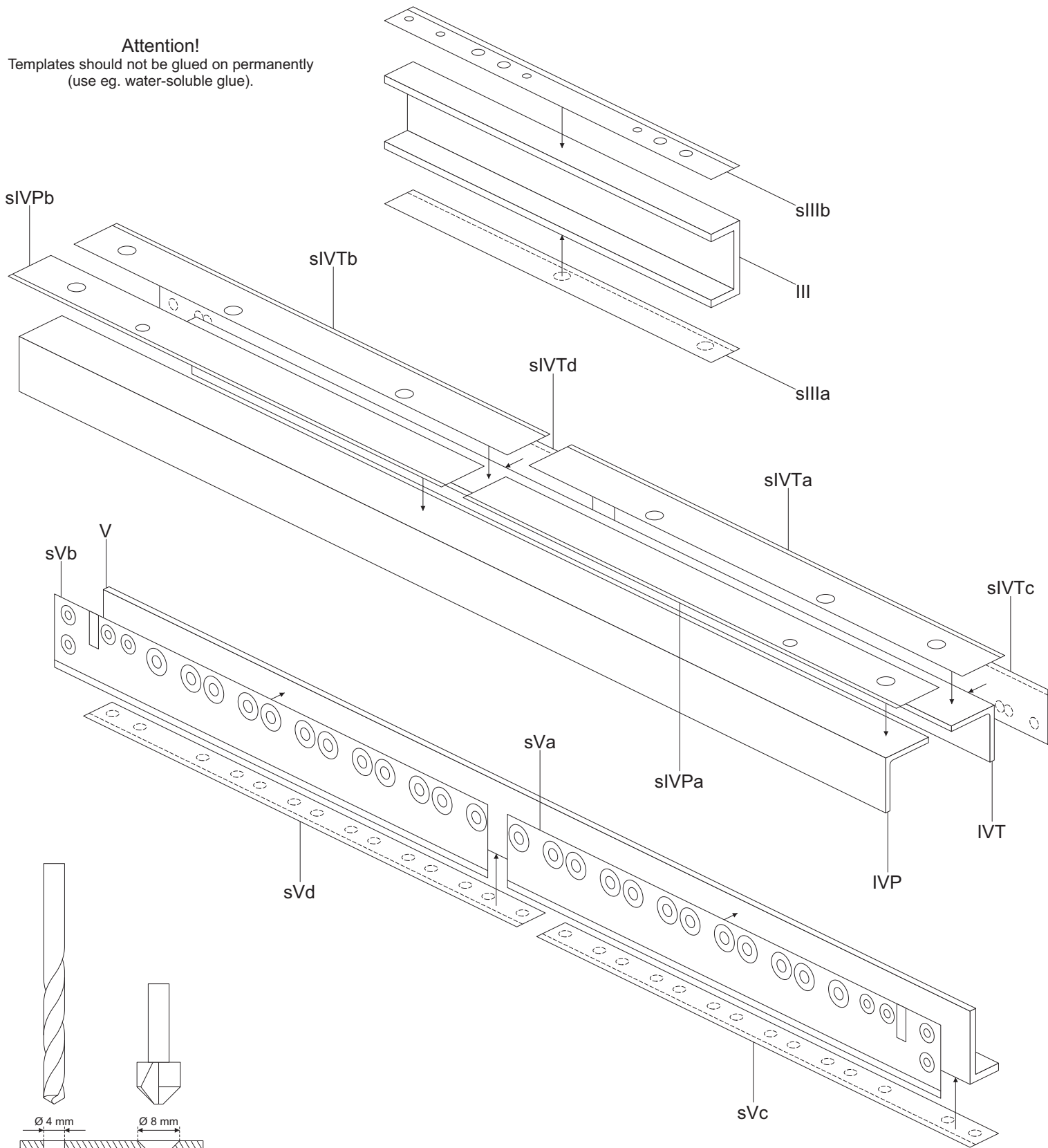

Ø 4 mm hole Ø 4 mm hole
 chamfered to Ø 8 mm

Example of drilling the holes

Block instrument base, scale 1:5

Assembly manual 3/16

Plates of the base
(variant made out of metal or plastic sheets)
Applying the drilling templates

Attention!
Templates should not be glued on permanently
(use eg. water-soluble glue).

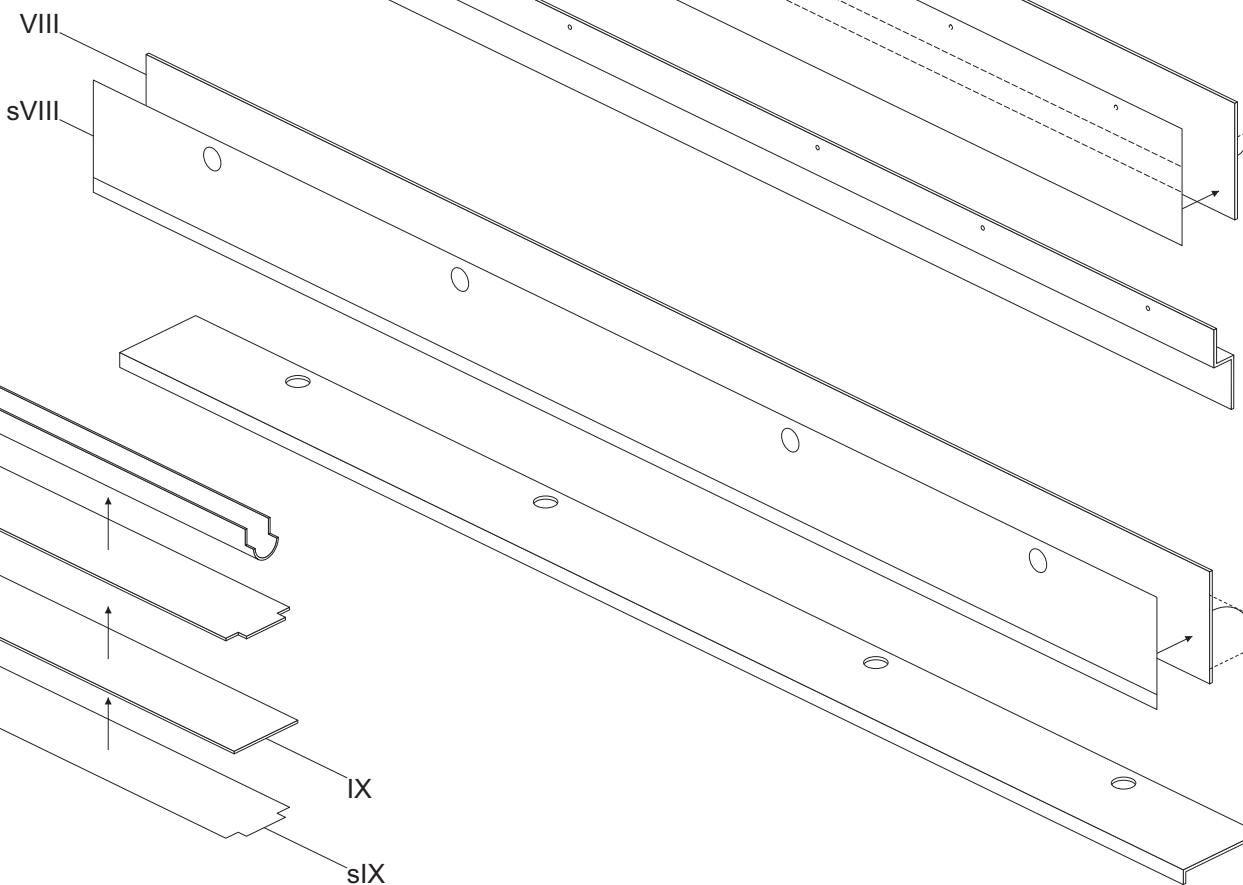
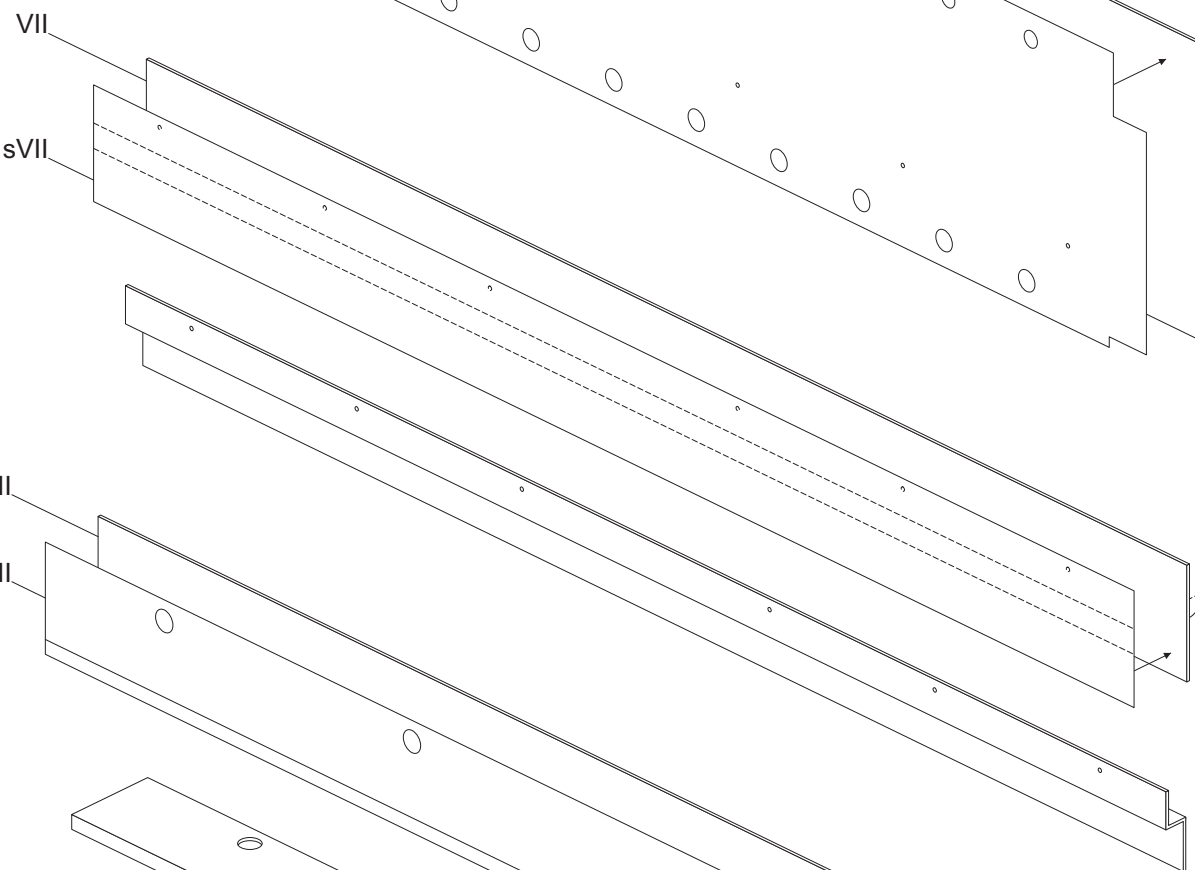
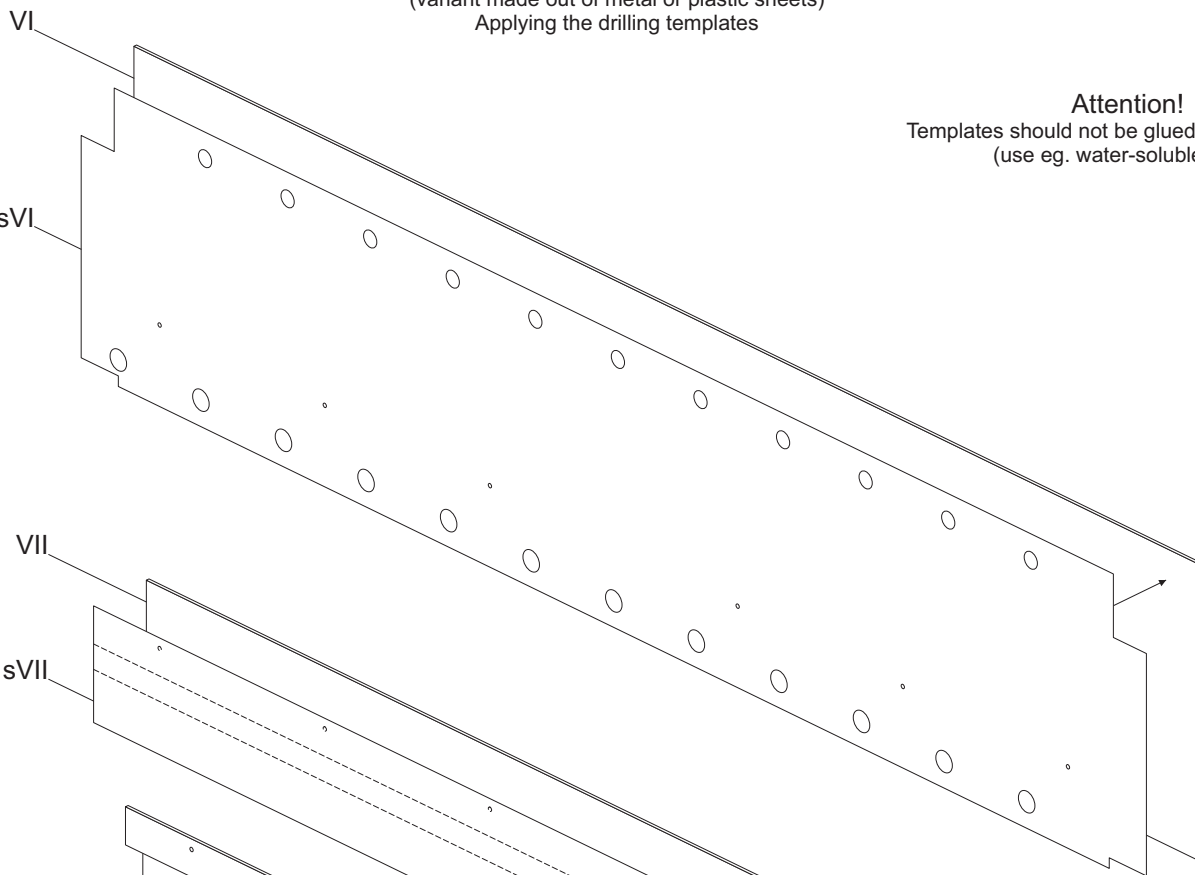

Block instrument base, scale 1:5

Assembly manual 4/16

Longerons of the base
(variant made out of 3D printed parts)

Attention!
Long parts may contract slightly during printing. Check the provided dimensions after print.

Selected parts may be longer than the print area. Place the parts diagonally to the print area in the slicing software.

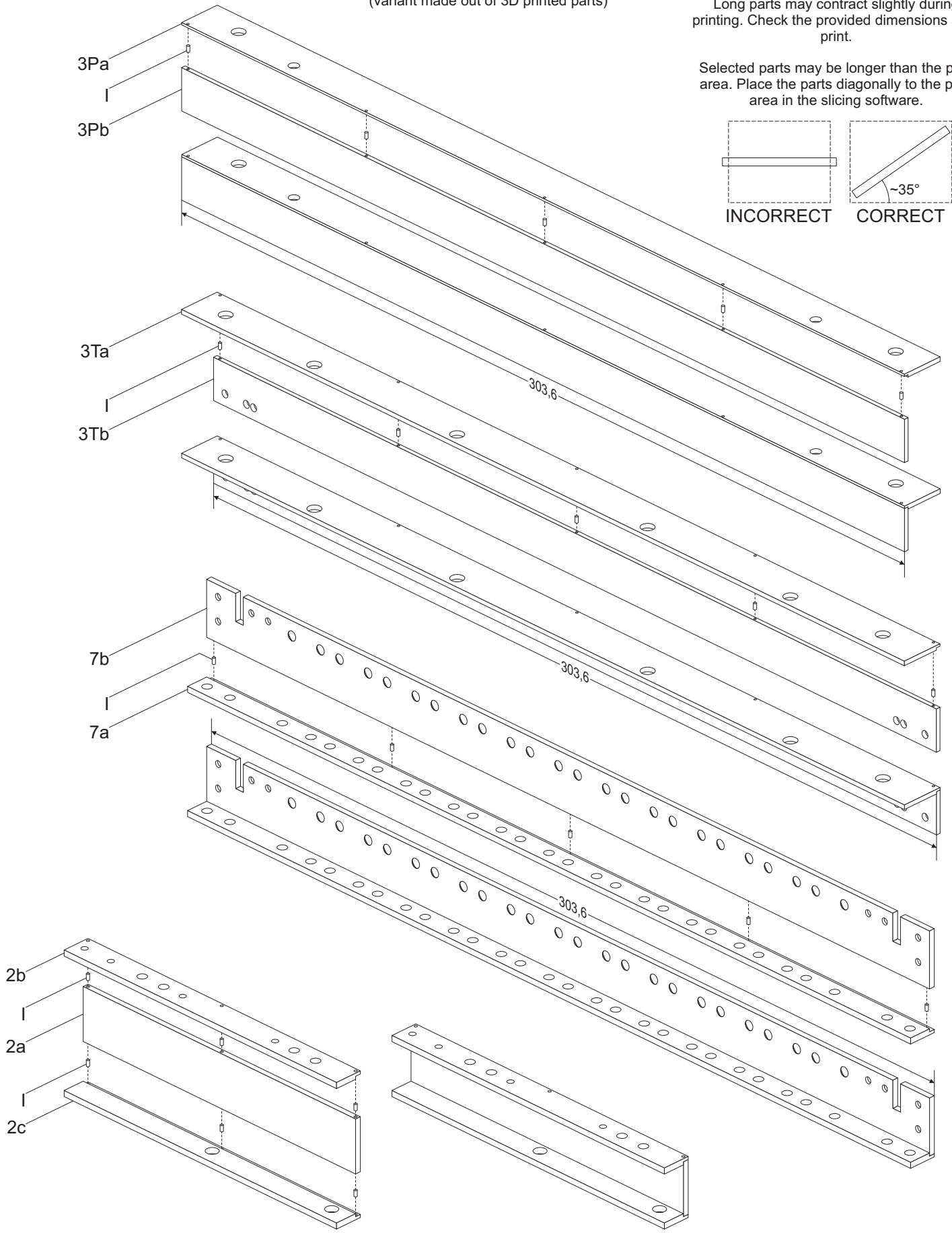
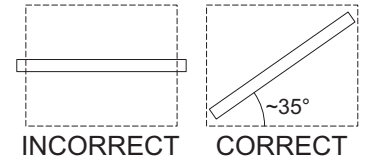

Block instrument base, scale 1:5

Assembly manual 5/16

Attention!
 Long parts may contract slightly during printing. Check the provided dimensions after print.

Selected parts may be longer than the print area. Place the parts diagonally to the print area in the slicing software.

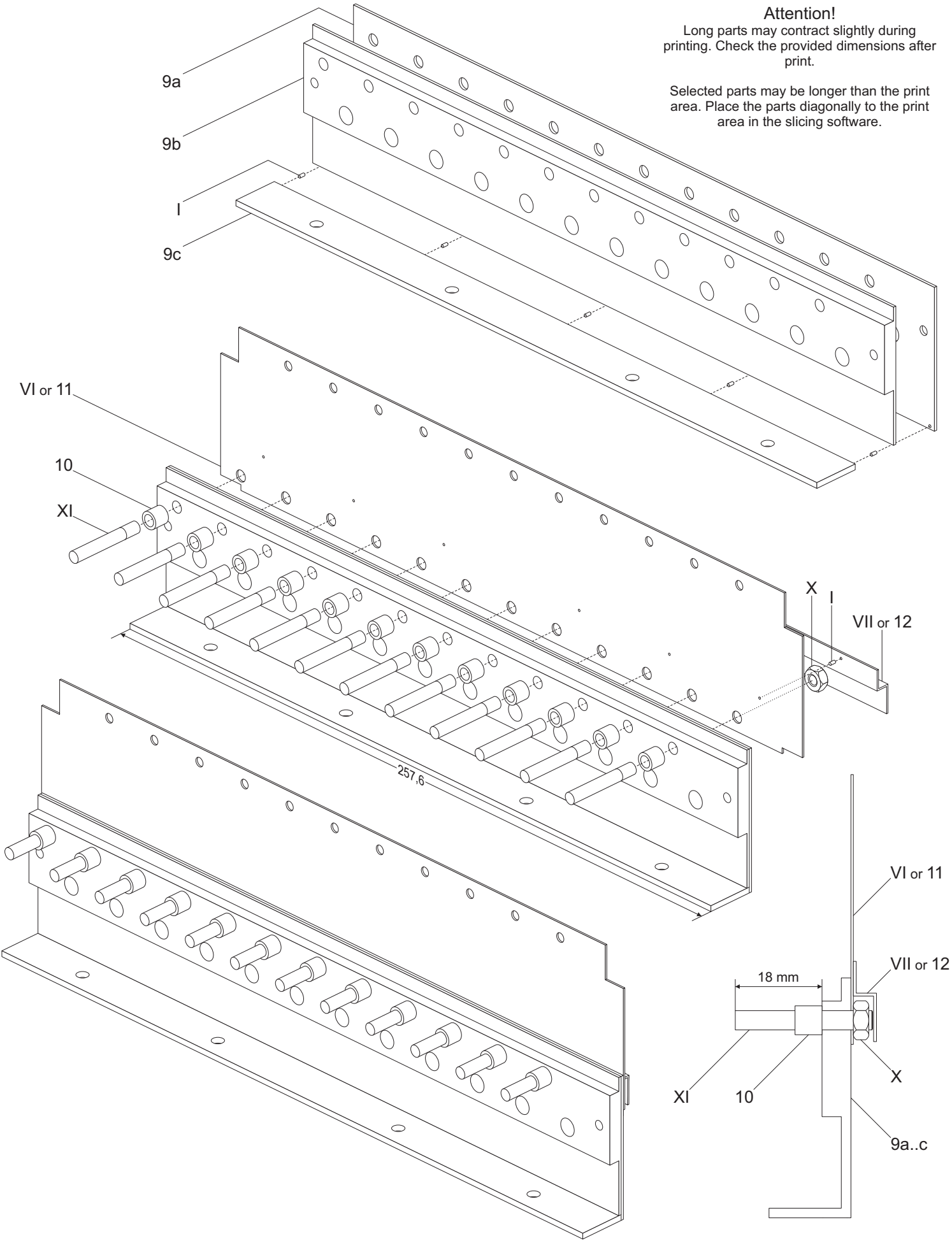

Block instrument base, scale 1:5

Assembly manual 6/16

Attention!

Long parts may contract slightly during printing. Check the provided dimensions after print.

Selected parts may be longer than the print area. Place the parts diagonally to the print area in the slicing software.

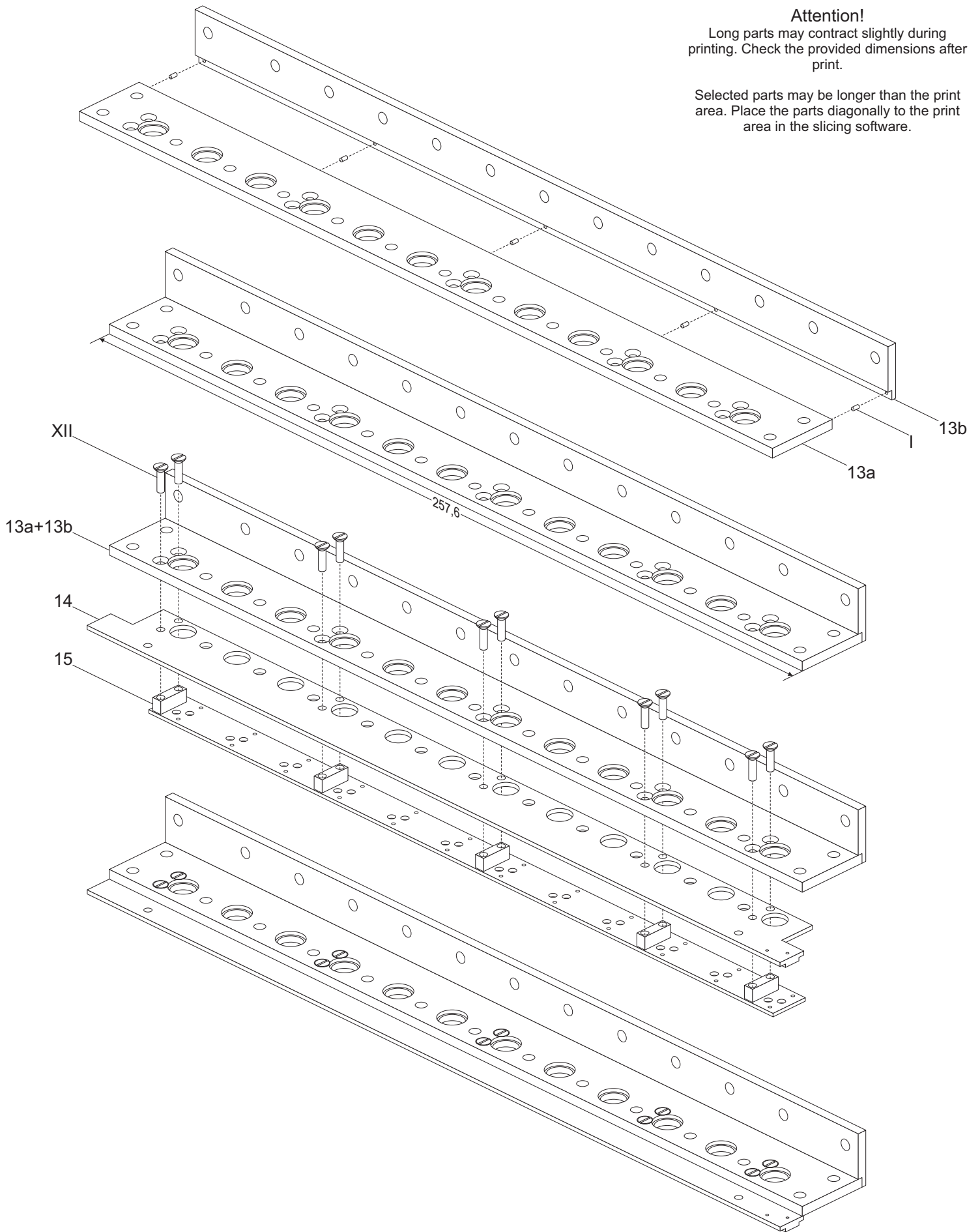

Block instrument base, scale 1:5

Assembly manual 7/16

Attention!

Long parts may contract slightly during printing. Check the provided dimensions after print.

Selected parts may be longer than the print area. Place the parts diagonally to the print area in the slicing software.

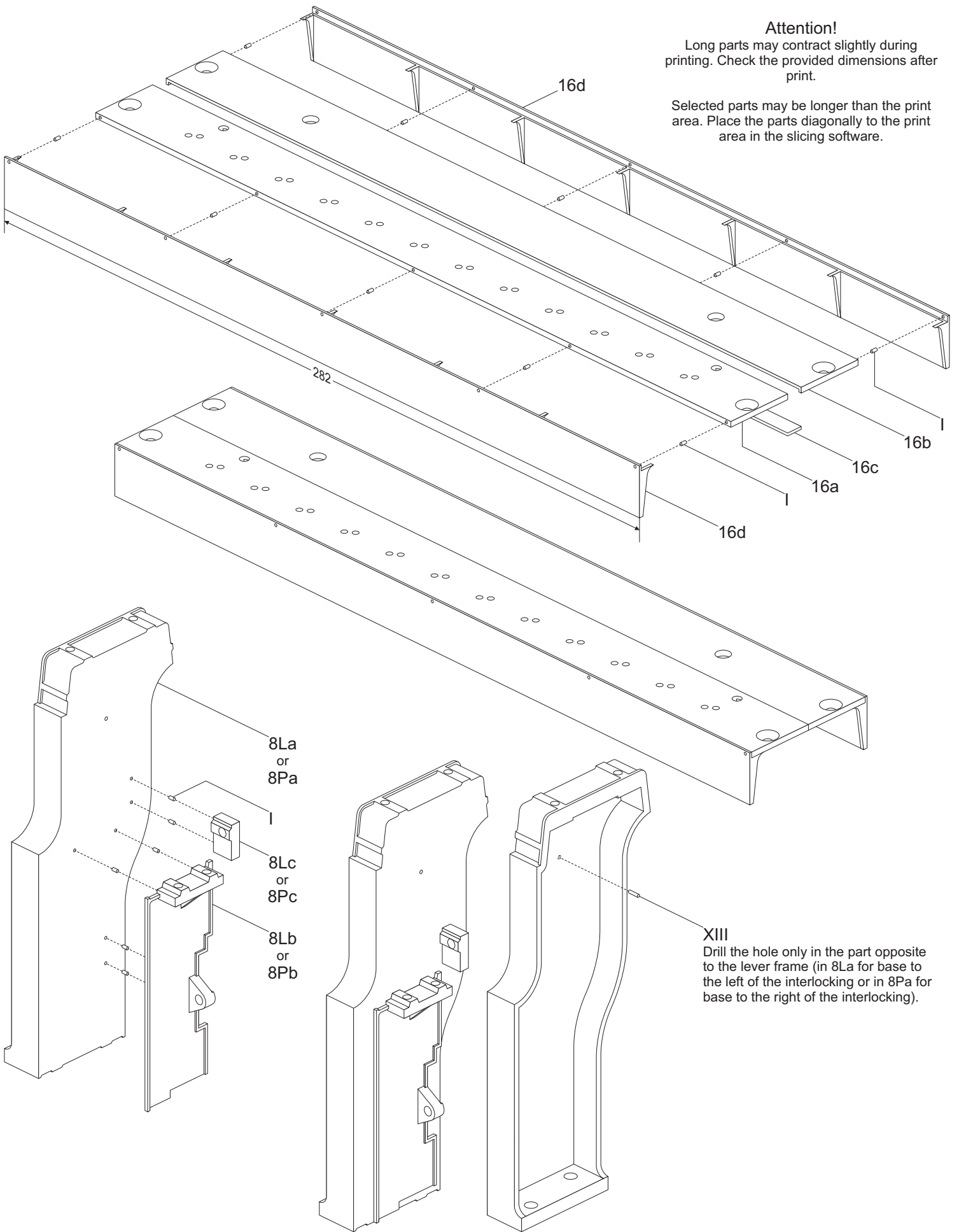

Block instrument base, scale 1:5

Assembly manual 8/16

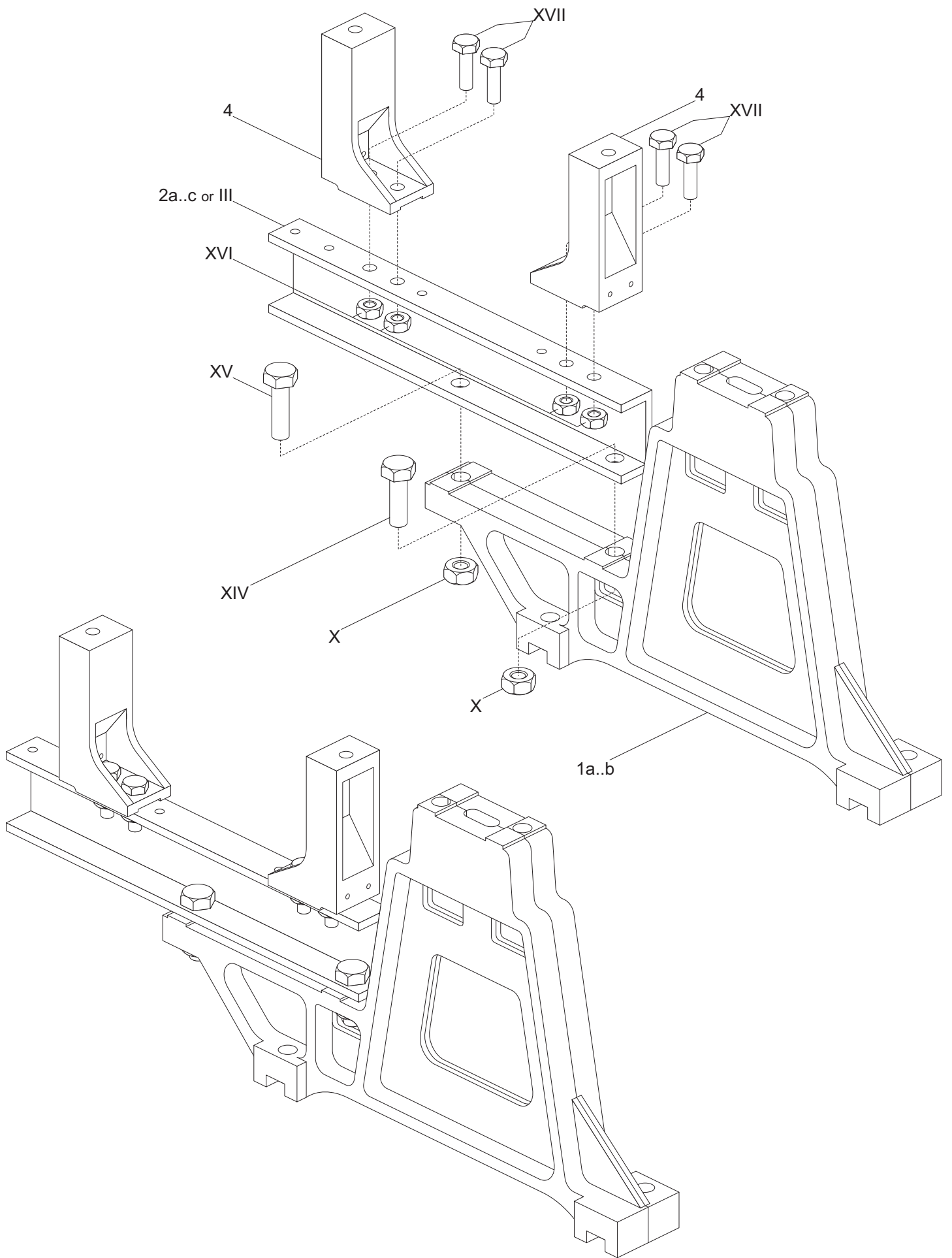

Block instrument base, scale 1:5

Assembly manual 9/16

Assembly of a base situated to the right of the lever frame is shown.
 In case of the base situated to the left of the lever frame, assembly is mirrored with part 6L replacing 6P.

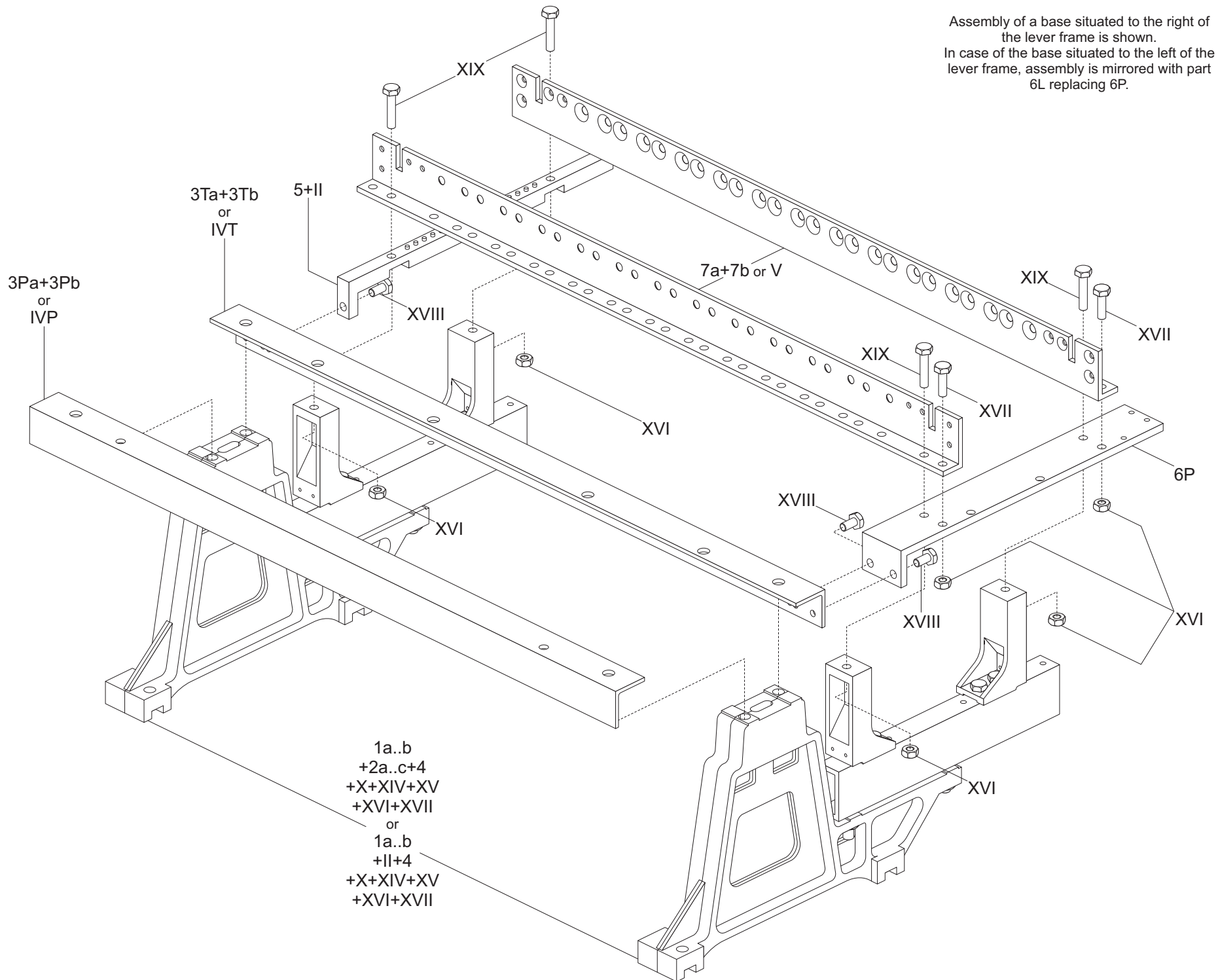

Block instrument base, scale 1:5

Assembly manual 10/16

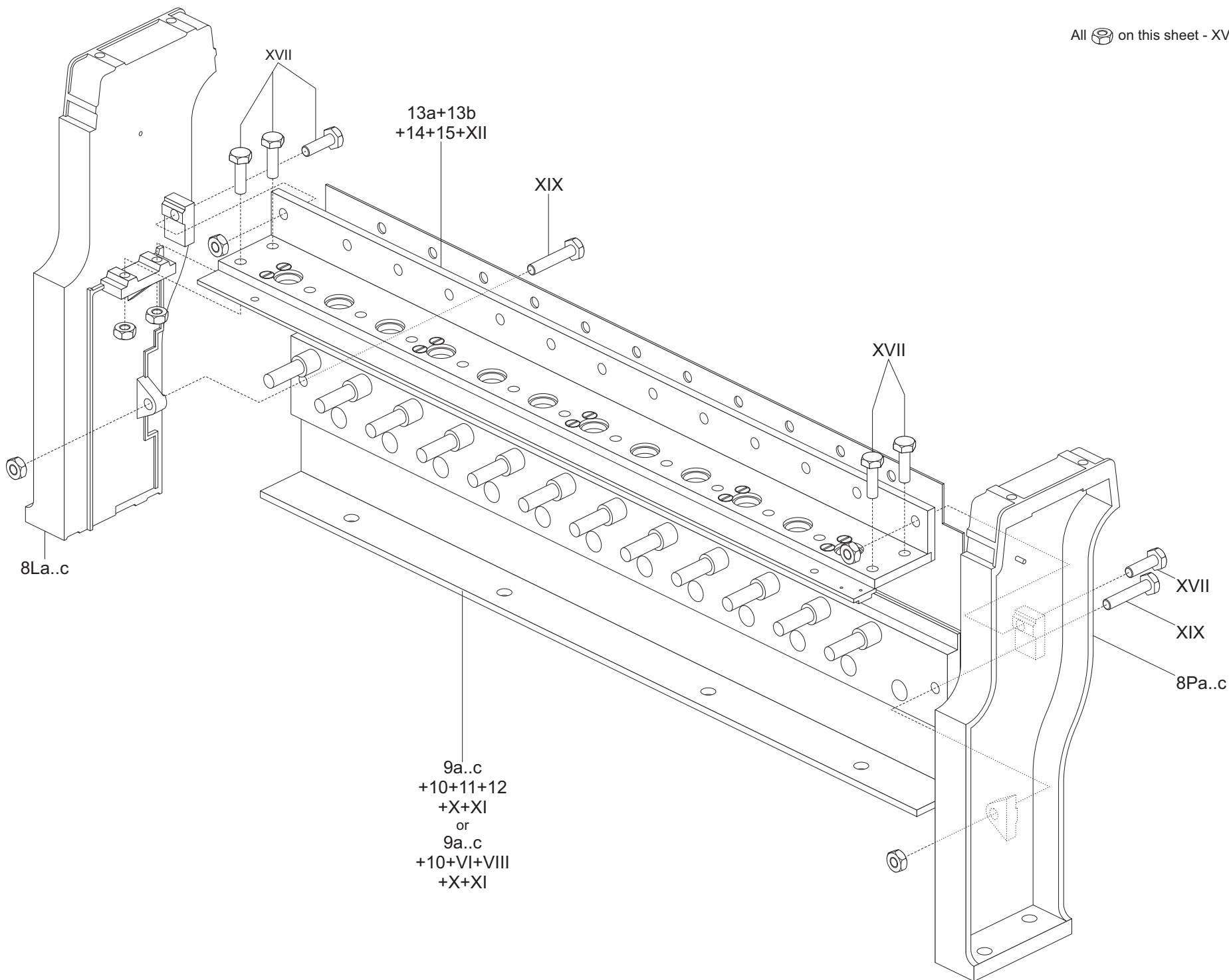

Block instrument base, scale 1:5

Assembly manual 11/16

Author: Paweł Adamowicz (<http://pkprepo.net/>), 2025-2026, selected rights reserved



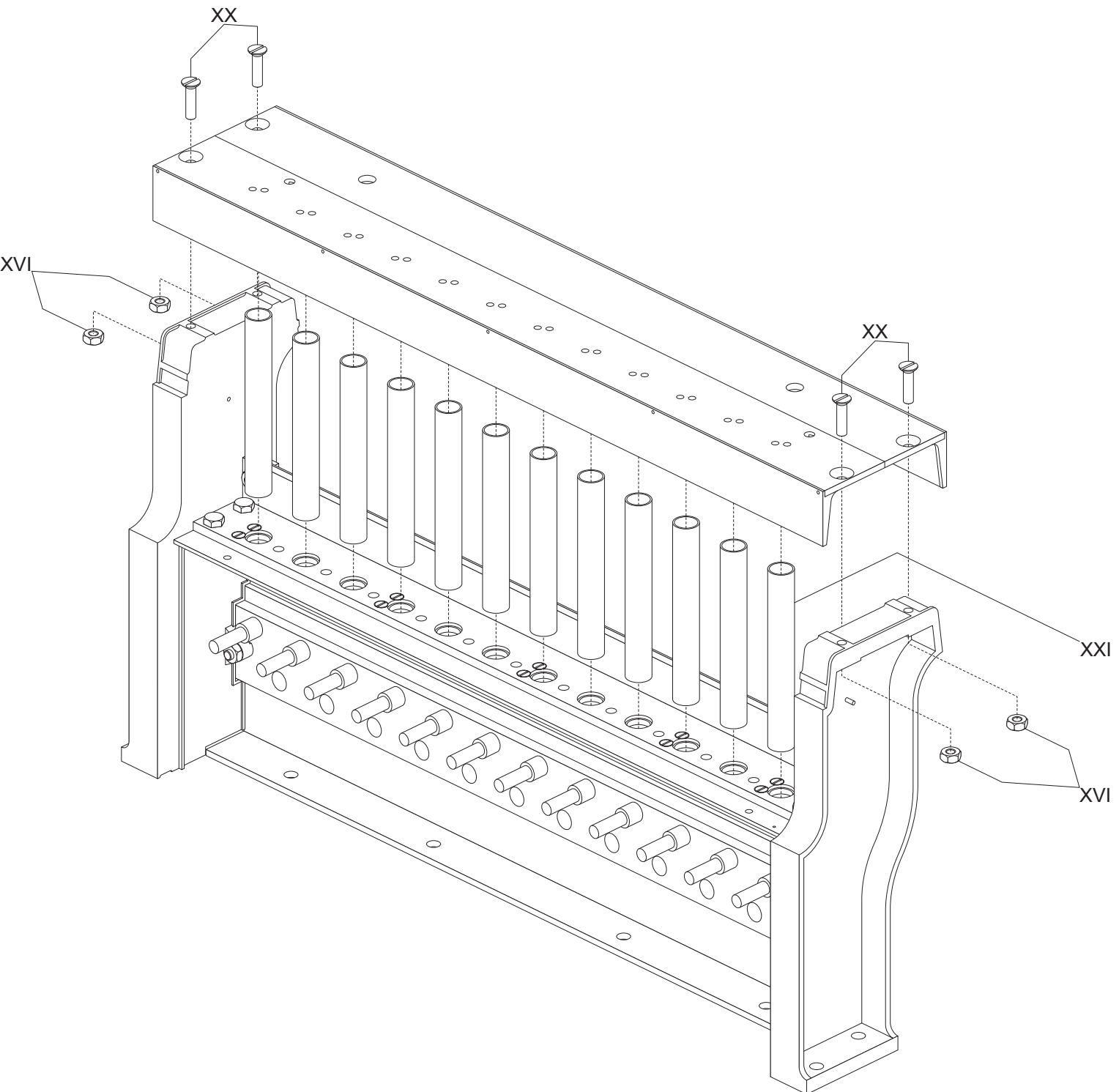

Block instrument base, scale 1:5

Assembly manual 12/16

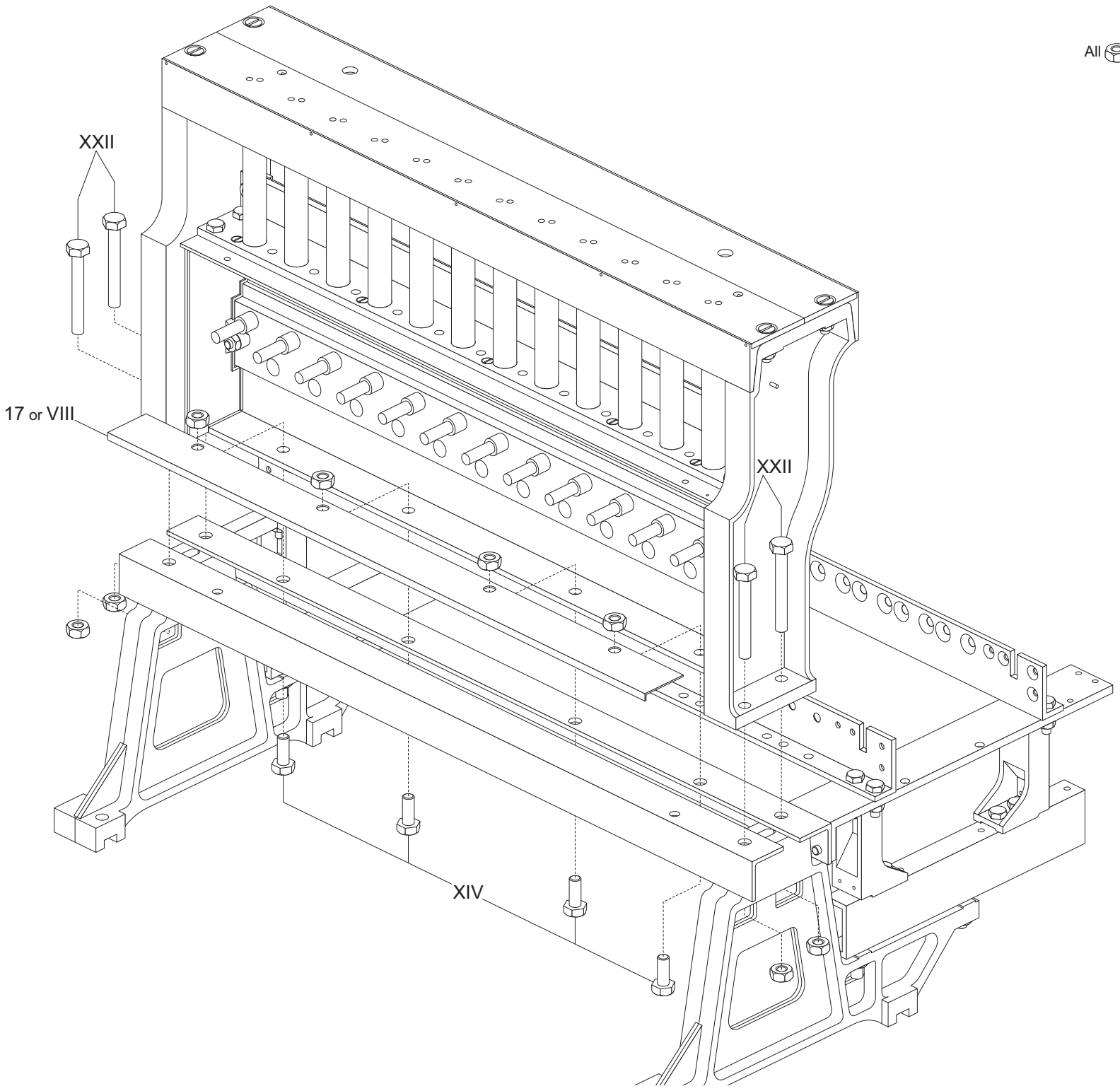

Block instrument base, scale 1:5

Assembly manual 13/16

Author: Paweł Adamowicz (<http://pkprepo.net/>), 2025-2026, selected rights reserved



All  on this sheet - XVI

All  on this sheet - XVII

All  on this sheet - XXIII

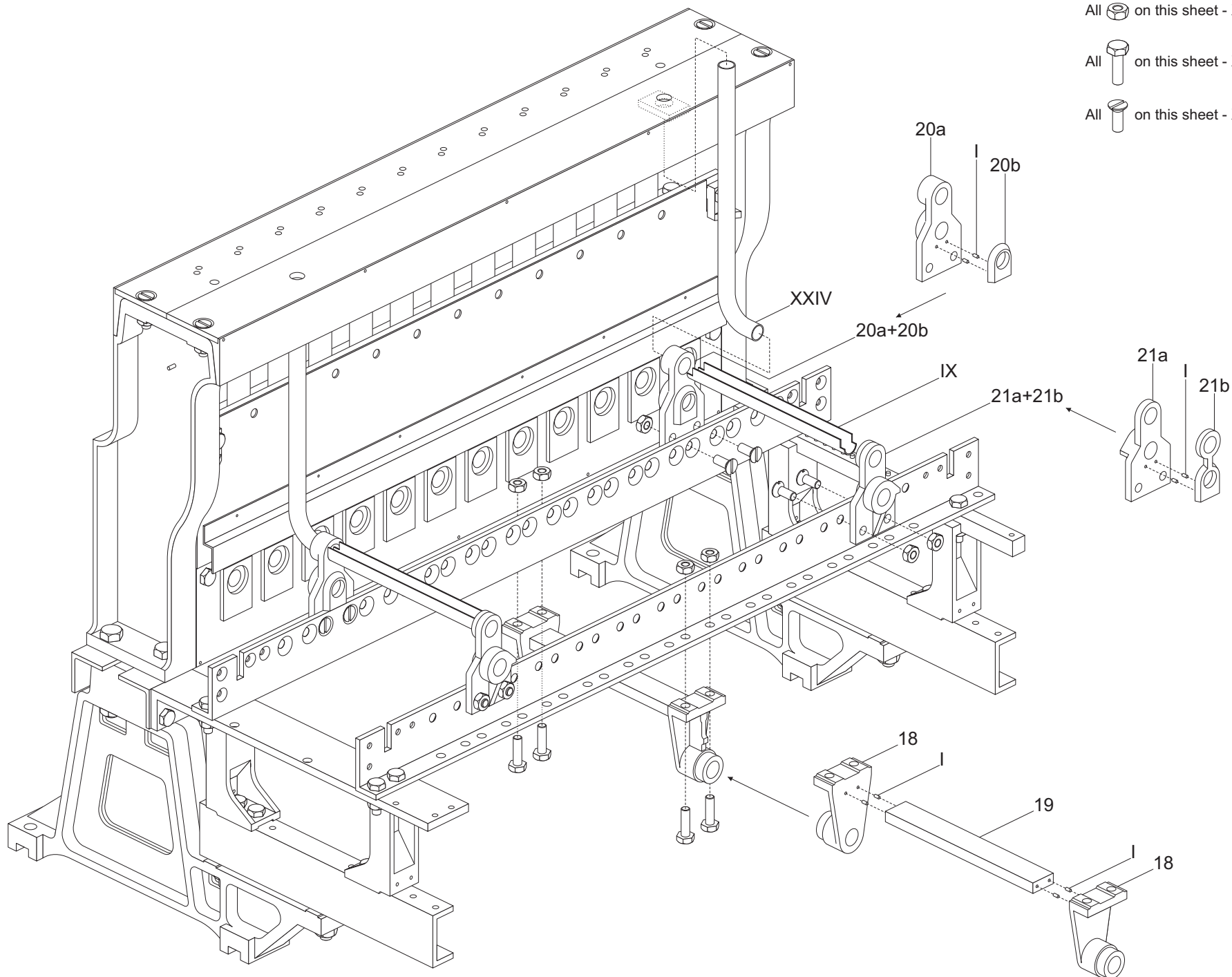

Block instrument base, scale 1:5

Assembly manual 14/16

Author: Paweł Adamowicz (<http://pkprepo.net/>), 2025-2026, selected rights reserved



Joining the base with the lever frame
Joint with the base to the right of the lever frame is shown,
for the base to the left the joint is mirrored.
The preparation of the lever frame for the join - see page 1 of the assembly manual.

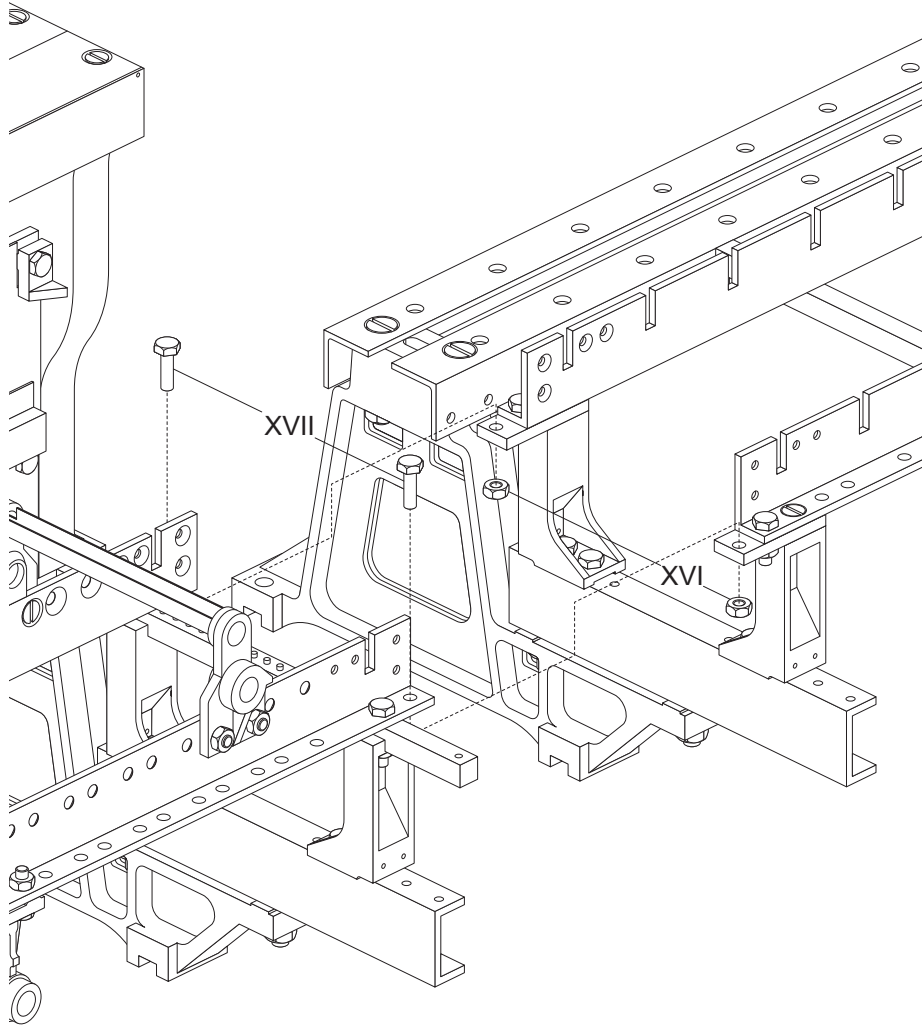
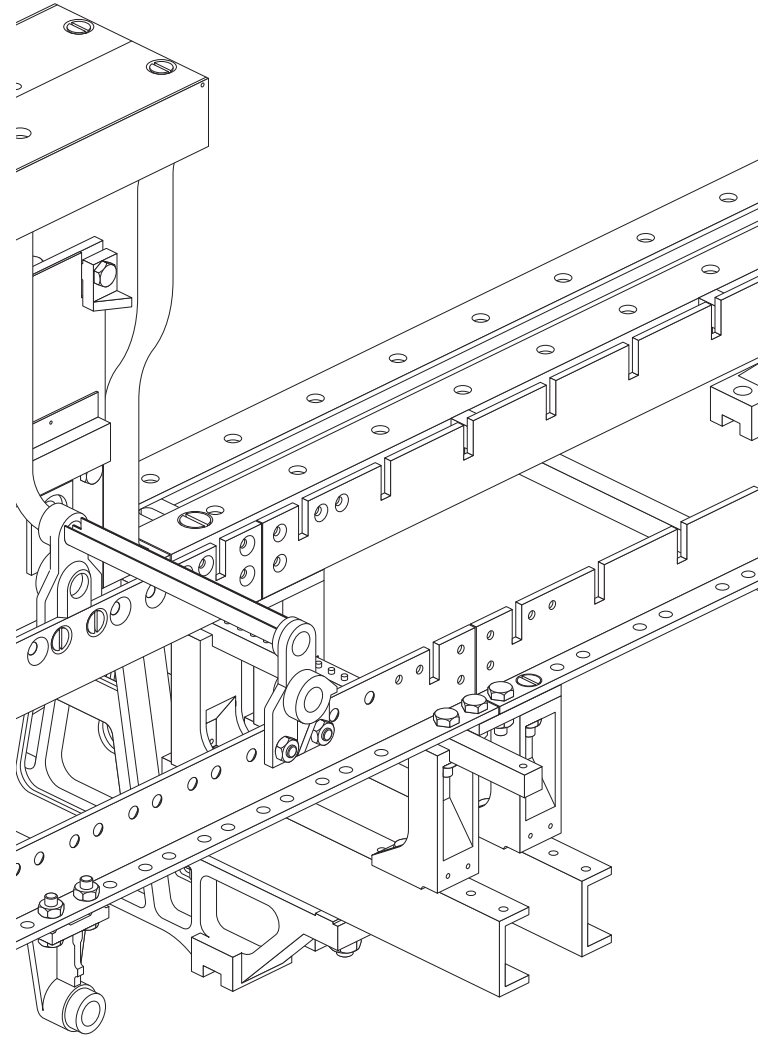

Block instrument base, scale 1:5

Assembly manual 15/16

Author: Paweł Adamowicz (<http://pkprepo.net/>), 2025-2026, selected rights reserved



Ds
Re-coupling bar for the levers, available as a separate download.

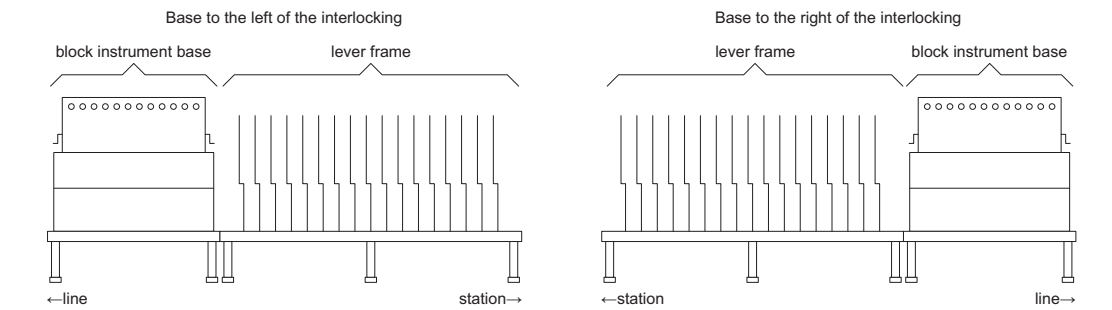
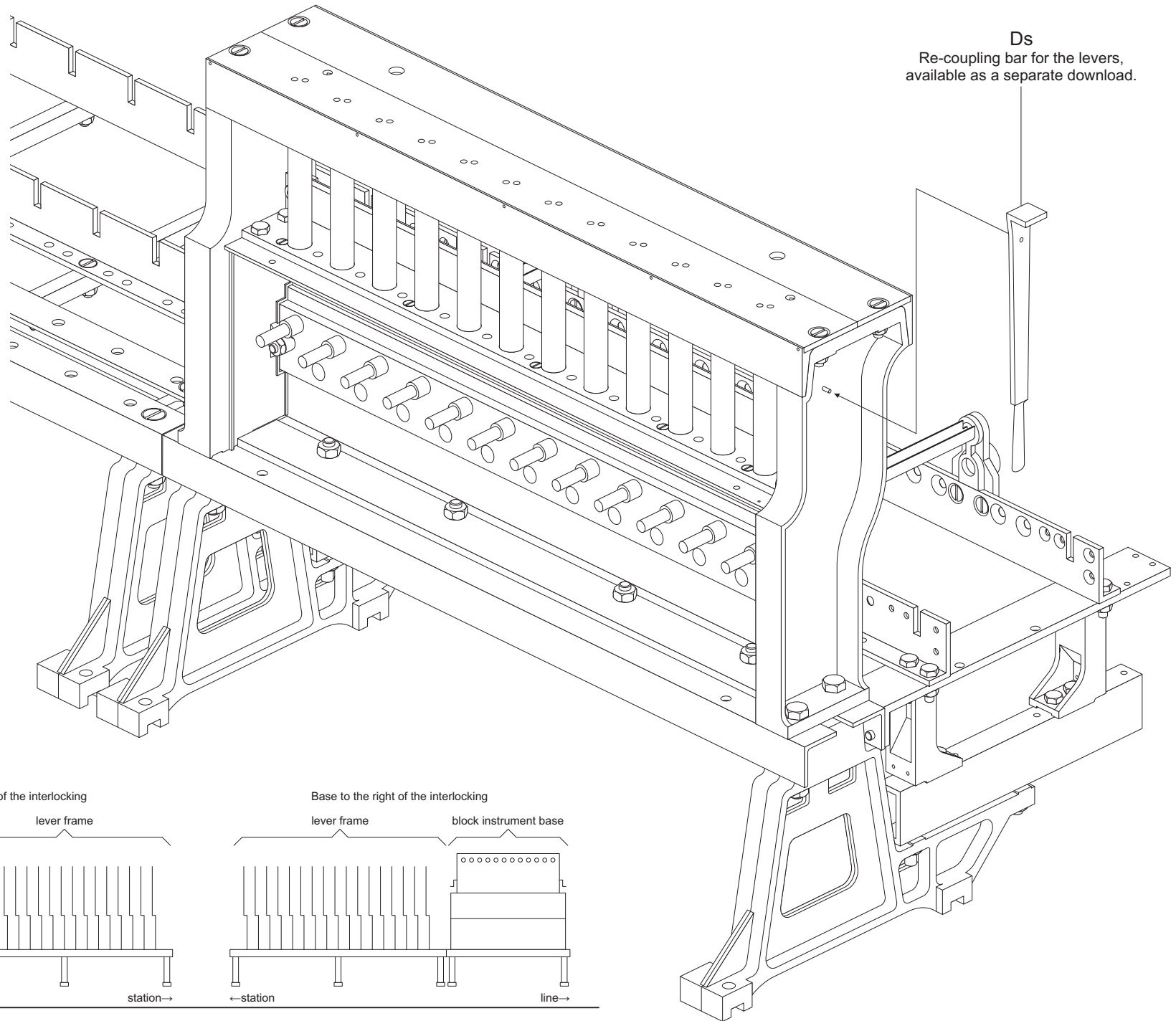

The interlocking is always facing the tracks.
Block instrument base must be placed towards the line (station entry).

Block instrument base, scale 1:5

Assembly manual 16/16